

PLANS

NOT

TO

SCALE



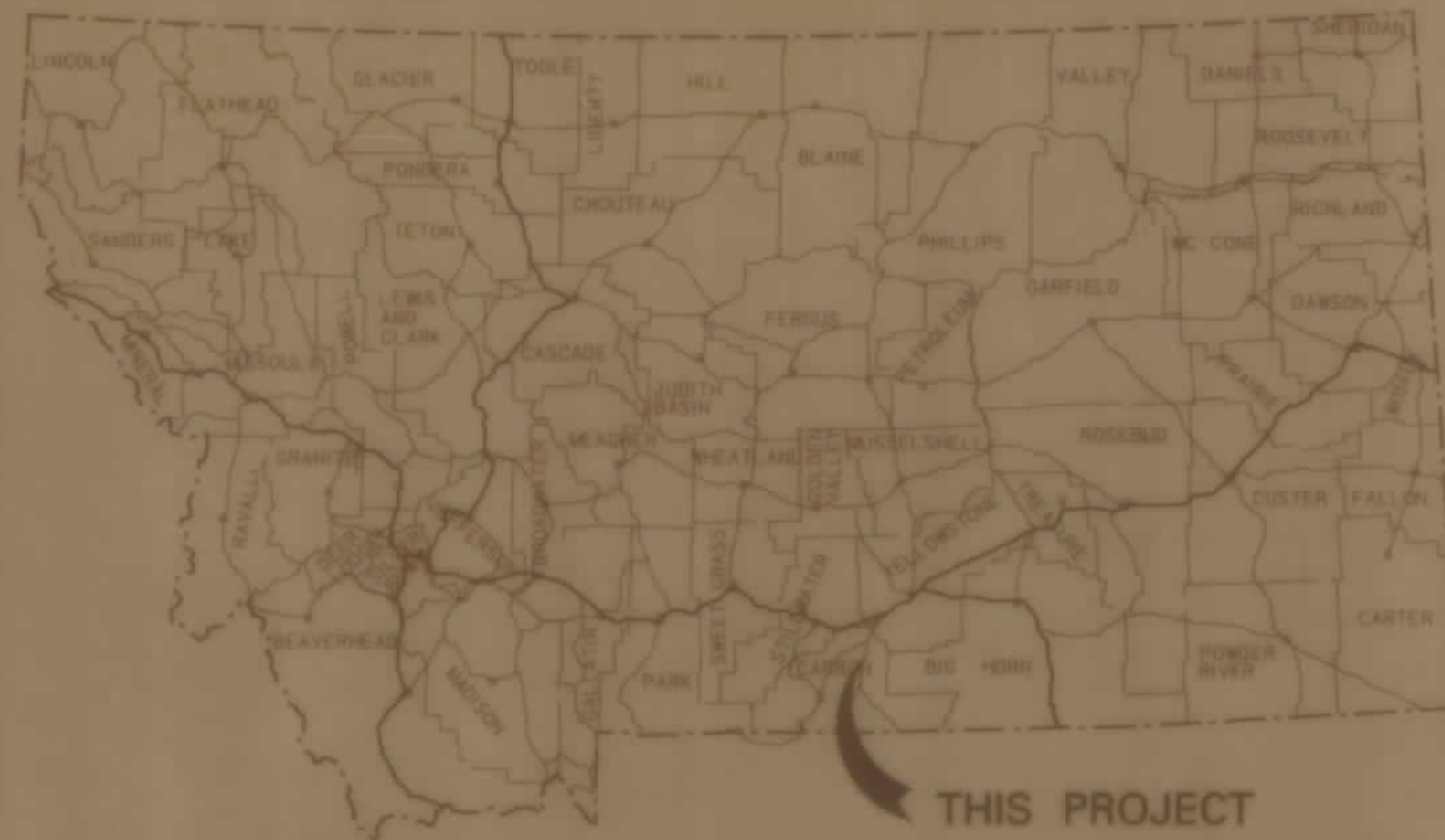

# MONTANA DEPARTMENT OF TRANSPORTATION

STATE	RIGHT OF WAY ID.	SHEET TOTAL	
		NO.	SHEETS
MONTANA	BR 9005 (20)	1	2
PROJECT NUMBER 2291-020			
CLARKS FORK OF THE YELLOWSTONE			

## RIGHT OF WAY PLAN OF FEDERAL AID PROJECT BR 9005 (20) CLARKS FORK OF THE YELLOWSTONE CARBON COUNTY

0.4 Kilometers

SEE SHEET NO. 2 FOR OWNERSHIP  
NAMES, ADDRESSES, AREAS, ETC.

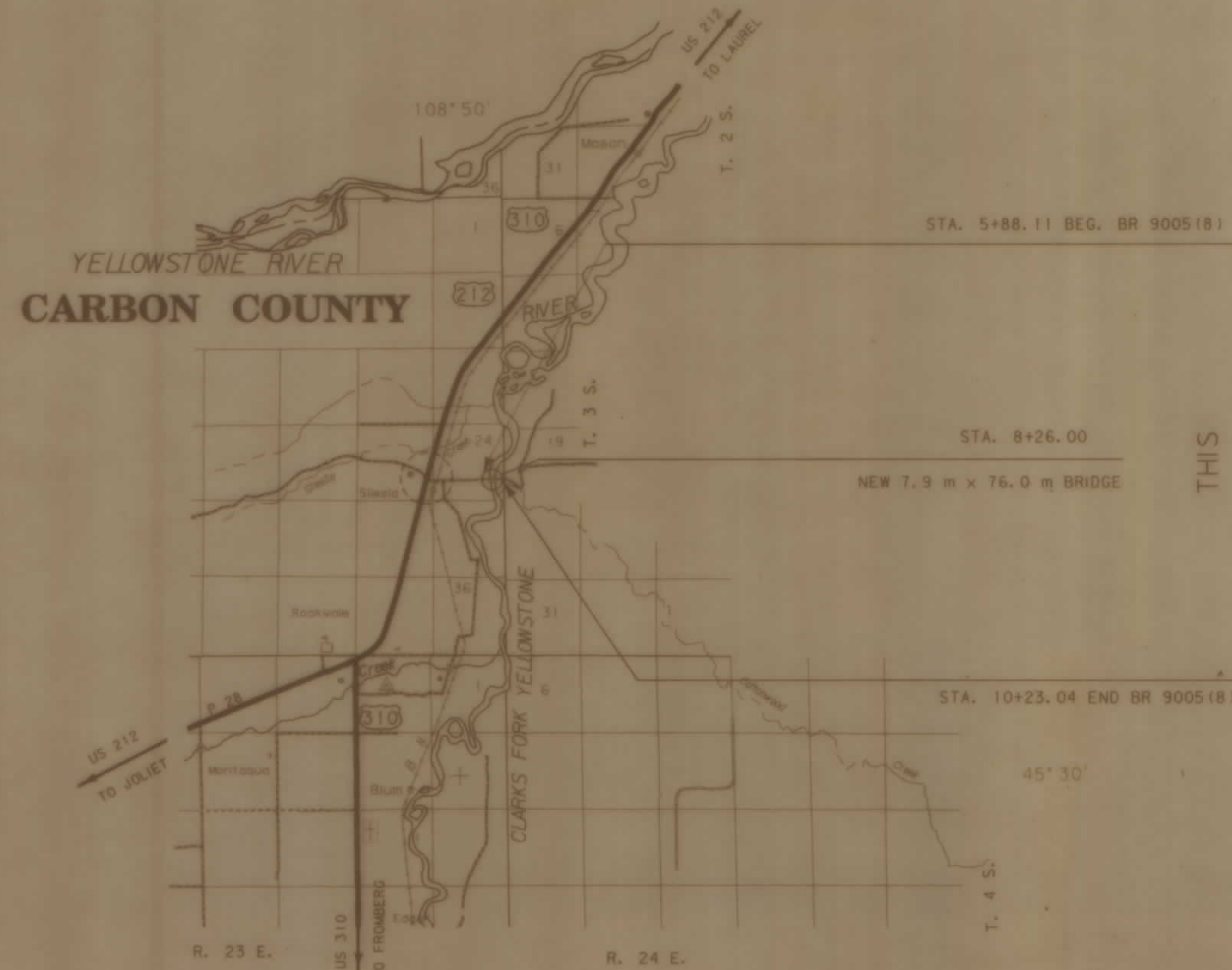

### CONVENTIONAL SIGNS

PROPOSED RIGHT OF WAY LINE	---
EXISTING RIGHT OF WAY LINE	---
RAILROAD RIGHT OF WAY LINE	---
CENTERLINE (C) OR PROJECTED LINE	---
STK'D CENTERLINE	---
SECTION LINE	---
OWNERSHIP BOUNDARY	---
FULL ACCESS CONTROL	---
LIMITED ACCESS CONTROL	---
EXISTING ACCESS CONTROL	---
PRESENT TRAVELED WAY (P.T.W.)	---
FENCE LINE	---
EXISTING GUARDRAIL	---
PROPOSED GUARDRAIL	---
GATE IN FENCE	---
CATTLE GUARD: EXIST. - PROPOSED	---
SECTION CORNER	FOUND UNFOUND
1/4 SECTION CORNER	---
CLOSING CORNER	---
MEANDER CORNER	---
CENTER OF SECTION	---
RIGHT OF WAY MONUMENT	---
PROPERTY CORNER PIN	---
POWER POLE IN PLACE	---
TELEPHONE POLE IN PLACE	---
TELEGRAPH POLE IN PLACE	---
LIGHT POLE	---
PROPOSED CULVERT	---
EXISTING CULVERT	---
OUTLET DITCH	---
INLET DITCH	---
EXISTING DITCH	---
CHANNEL CHANGES	---
DITCH BLOCK	---
RIPRAP	---
BRIDGES	---
RAILROADS	---
PARCEL NUMBERS	---
APPROACH: EXIST. - PROPOSED	---

ASSOCIATED PROJECT  
ID.

RELATED PROJECTS

FWHA/MDT APPROVAL 3-22-98

MAP REVISED

NOTES: 1. ALL MEASUREMENTS ARE METRIC EXCEPT AS NOTED



OWNERSHIP																			
PARCEL	NAME	ADDRESS	TOTAL AREA		GROSS R/W AREA		EX. EASE. AREA		NET AREA		REMAINDER				CONST. PMT. AREA		EASE. AREA		SHEET NO.
			METRIC	ENGLISH	METRIC	ENGLISH	METRIC	ENGLISH	METRIC	ENGLISH	LEFT		RIGHT		METRIC	ENGLISH	METRIC	ENGLISH	
											METRIC	ENGLISH	METRIC	ENGLISH					
1	RAYMOND A. AND RUTH GUENTHNER	3387 U.S. HWY. 212 S., LAUREL, MT 59044	64.751 ha	160+ AC	*0.871 ha	2.15 AC	0.523 ha	1.29 AC	0.348 ha	0.86 AC									
2	PAUL T. AND SYLVIA R. HAFNER	ROUTE 1, BOX 126 E. SILESIA, MT 59041	34.398 ha	85 AC	*0.226 ha	0.56 AC	0.226 ha	0.56 AC			34.172 ha	84.44 AC			0.033 ha	0.08 AC			
3	ELIZABETH BRIGGS	ROUTE 1, BOX 127, SILESIA, MT 59041	48.562 ha	120 AC	*0.492 ha	1.22 AC	0.233 ha	0.58 AC	0.259 ha	0.64 AC			48.070 ha	118.78 AC					

STATE	RIGHT OF WAY ID.	SHEET NO.	TOTAL SHEETS
MONTANA	BR 9005 (20)	2	2
PROJECT NUMBER 2291-020			
CLARKS FORK OF THE YELLOWSTONE			

\*TO BE ACQUIRED AS EASEMENT IN THE NAME OF CARBON COUNTY

T. 3 S. R. 23 E.

NE<sup>4</sup> SW<sup>4</sup>  
SEC. 24

PI 6+88.28 IS S44°27'23"E,  
1523.98 m FROM THE NW CORNER  
OF SECTION 24, (5/8" REBAR)

U. S. GOVT.  
LOT 6  
SEC. 24

U. S. GOVT.  
LOT 5  
SEC. 24

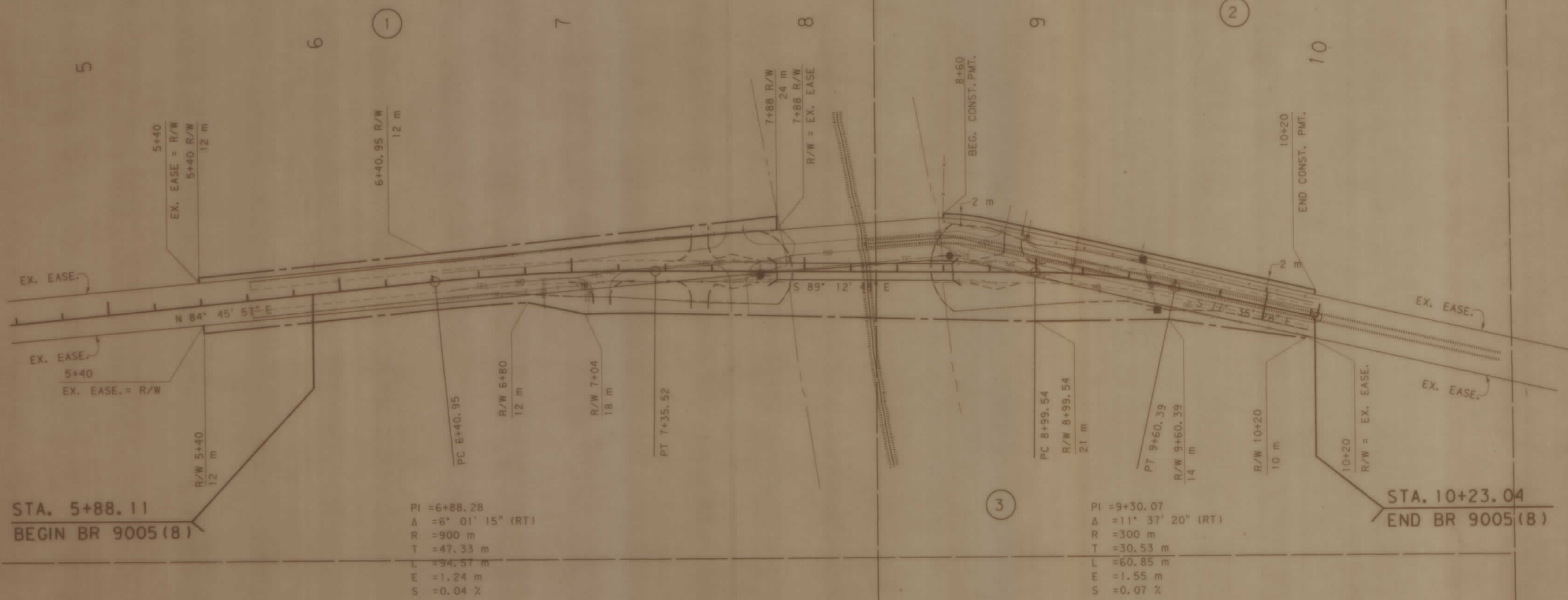

STA. 5+88.11  
BEGIN BR 9005(8)

PI = 6+88.28  
Δ = 6° 01' 15" (RT)  
R = 900 m  
T = 47.33 m  
L = 94.51 m  
E = 1.24 m  
S = 0.04 %

PI = 9+30.07  
Δ = 11° 37' 20" (RT)  
R = 300 m  
T = 30.53 m  
L = 60.85 m  
E = 1.55 m  
S = 0.07 %

STA. 10+23.04  
END BR 9005(8)

U. S. GOVT.  
LOT 7  
SEC. 24

SE<sup>4</sup> SW<sup>4</sup>  
SEC. 24

NOTES: 1. ALL MEASUREMENTS ARE METRIC EXCEPT AS NOTED  
2. THE PROPOSED R/W LINE WHERE A SPIRAL CURVE TRANSITION IS USED IS A CHORD RATHER THAN A CONCENTRIC CURVE.

BACKSLOPE LIMITS INCLUDE ROUNDING  
CONSTRUCTION LIMITS: CUT SECTION TOE OF FILL

FHWA/DOT APPROVAL 3-22-96

MAP REVISED

MONTANA DEPARTMENT OF TRANSPORTATION  
RIGHT OF WAY PLAN  
CARBON COUNTY  
SCALE 1"=1000'

0 50M 100M