

Return To:  
Morrison-Maierle, Inc.  
Attn: Mark Maierle, P.E.  
2880 Technology Blvd. West  
Bozeman, MT 59718

**2524943**  
Page: 1 of 4 09/16/2015 03:22:34 PM Fee: \$0.00  
Charlotte Mills - Gallatin County, MT MISC

County: Gallatin  
Designation: Airway Blvd.  
Project No.: 0761.123

**Highway Easement**

**This Easement**, made this 15th day of September, 2015, in consideration of the sum of One Dollar (\$1.00) and other good and valuable consideration now paid, the receipt of which is acknowledged, **witnesses that**,

Gallatin Airport Authority, a body corporate and politic of the State of Montana  
850 Gallatin Field Road, Suite 6  
Belgrade, MT 59714

do(es) hereby **grant, bargain, sell and convey** unto **Gallatin County**, an easement and right-of-way for highway purposes, including the construction, reconstruction and maintenance of a highway over, across, and the right of entry upon and occupation of lands. Reconstruction and maintenance of a highway, including maintenance of pavements, stripes, signage, chip seal, culverts and snow removal, covering and embracing the following described land:

Said Easement covers and embraces the following described land:

A tract of land in Section 1, T1S, R5E, & section 6 T1S, R5E, PMM Montana , and displayed on the exhibits consisting of 2 sheets, Airway Blvd 120' Easement Exhibits Fig. 1 & Fig. 2, attached hereto and made a part hereof, containing an area of 13.04 acres, more or less.

Permission is hereby granted to the Gallatin Airport Authority to have access approaches purposes described as follows:

A.	Station <u>128+18.31</u>	Public Approach	<u>RT Existing</u>
B.	Station <u>128+18.31</u>	Public/Private Approach	<u>LT &amp; Future</u>
C.	Station <u>134+04.09</u>	Public Approach	<u>LT Existing</u>
D.	Station <u>134+04.09</u>	Public/Private Approach	<u>RT Future</u>
E.	Station <u>146+41.69</u>	Public/Private Approach	<u>LT &amp; RT Future</u>
F.	Station <u>157+91.69</u>	Public/Private Approach	<u>LT &amp; RT Future</u>
G.	Station <u>163+35.92</u>	Public Round-About	<u>CL Existing</u>
approaches.			

It is understood and agreed by the parties hereto that the location of these approaches are subject to adjustment at the time of construction to achieve the best physical location for said approaches. Adjustments exceeding 300' from the specified location requires concurrence of the County.

Highway Easement  
County: Gallatin  
Designation: Airway Blvd.

Gallatin Airport Authority shall construct and maintain, at their sole expense, all approaches identified in this agreement. The Gallatin Airport Authority further agrees to conduct maintenance activities in a prudent manner providing for the safe and continued operation of thru traffic on the highway.

All drainage facilities within the existing right-of-way/easement associated with these approaches, i.e., approach culverts, drainage ditches, will be maintained by Gallatin County.

The existing roadway also includes an asphalt roundabout, asphalt trail and lighting improvements installed by the Gallatin Airport Authority. The Gallatin Airport Authority shall maintain said roundabout, trail and lighting improvements and shall complete necessary mowing of grass within the right-of-way. The Agreement shall authorize the Gallatin Airport Authority the right to access the right-of-way to complete construction of maintenance described within. All other maintenance shall be completed by Gallatin County, as previously discussed.

TO HAVE AND TO HOLD all of the above-described property unto Gallatin County, and to its successors and assigns as long as the same is used for highway purposes.

This easement was executed on the date of its last acknowledgment.

Theodore E Mathis as Chairman of Gallatin Airport Authority  
(Signature) (Type of Authority) (Name of Entity)

State of Montana  
County of Gallatin

This instrument was acknowledged before me on September 10, 2015  
(date)

by Theodore E. Mathis  
(name of person(s))

as Chairman  
(type of authority, e.g.; president, trustee, member, partner, etc.)

of Gallatin Airport Authority  
(name of entity on behalf of whom instrument was executed)

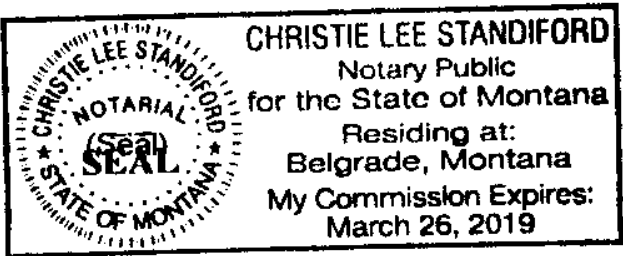

Christie Lee Standiford  
Notary Signature Line

CHRISTIE LEE STANDIFORD  
Notary Printed Name

Notary Public for the State of Montana  
Residing at: Belgrade, MT  
My Commission Expires: 03 / 26 / 19

This easement, including all terms and conditions, was excepted by Gallatin County on 09/15/2015  
(date)

BY: [Signature] as Chairman of Gallatin County Commission  
(Signature) (Type of Authority) (Name of Entity)

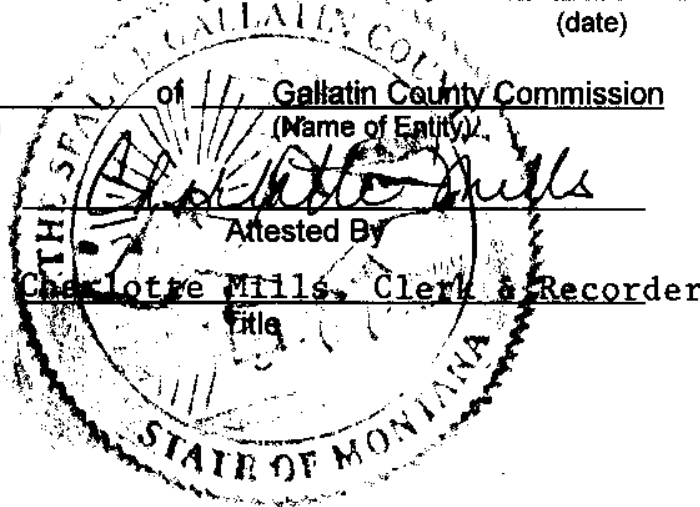

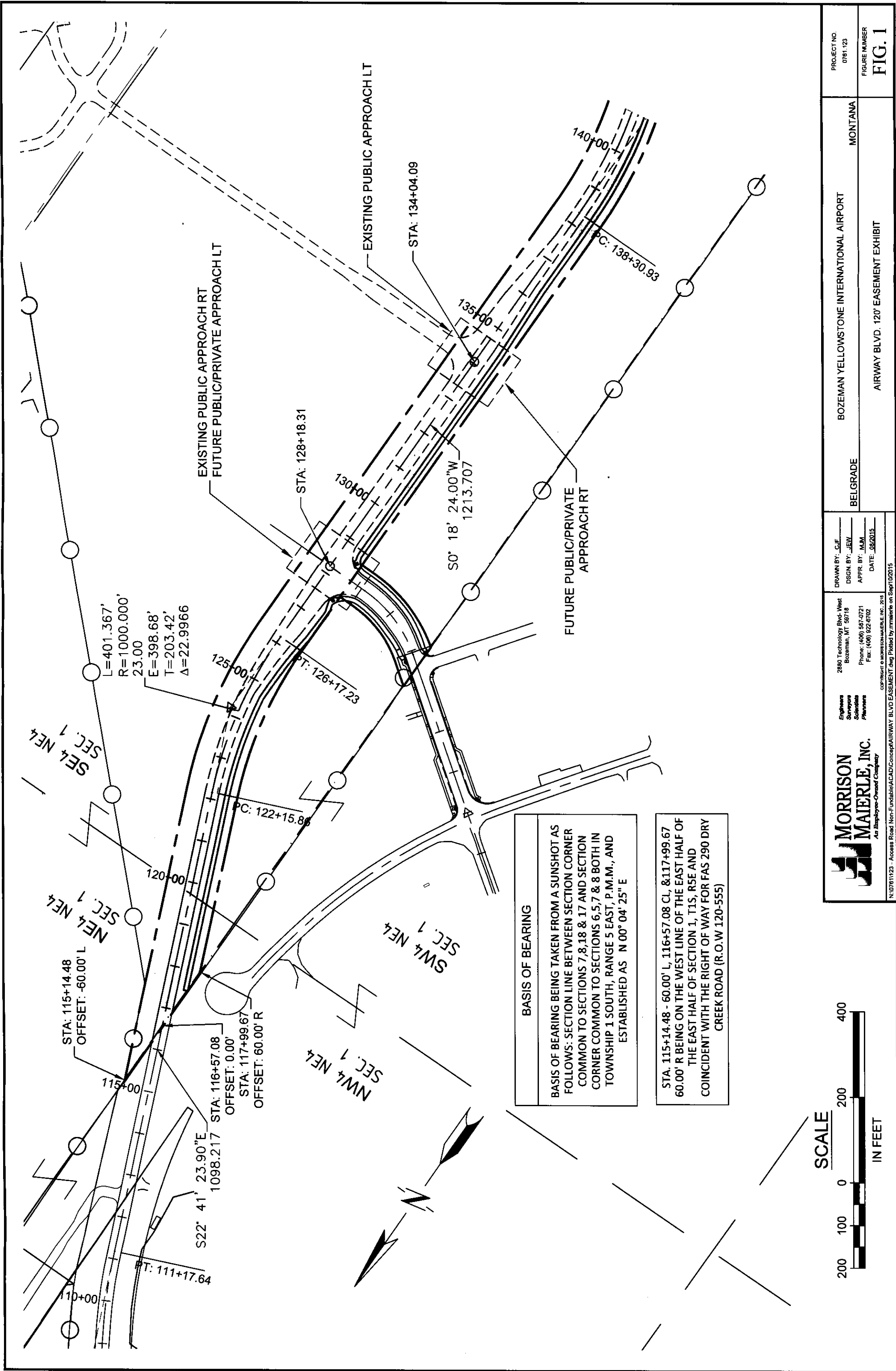

<b>MORRISON MAIERLE, INC.</b> A Subsidiary of Morrison-Maierle, Inc.		2880 Technology Blvd West Bozeman, MT 59718 Phone: (406) 587-0721 Fax: (406) 922-6702	DRAWN BY: C.F. DSGN BY: J.E.W. APPR BY: M.M. DATE: 08/20/15
<b>BOZEMAN YELLOWSTONE INTERNATIONAL AIRPORT</b>		<b>BELGRADE</b>	<b>MONTANA</b>
<b>PROJECT NO. 0781.123</b>		<b>FIG. 1</b>	
<b>AIRWAY BLVD. 120' EASEMENT EXHIBIT</b>			

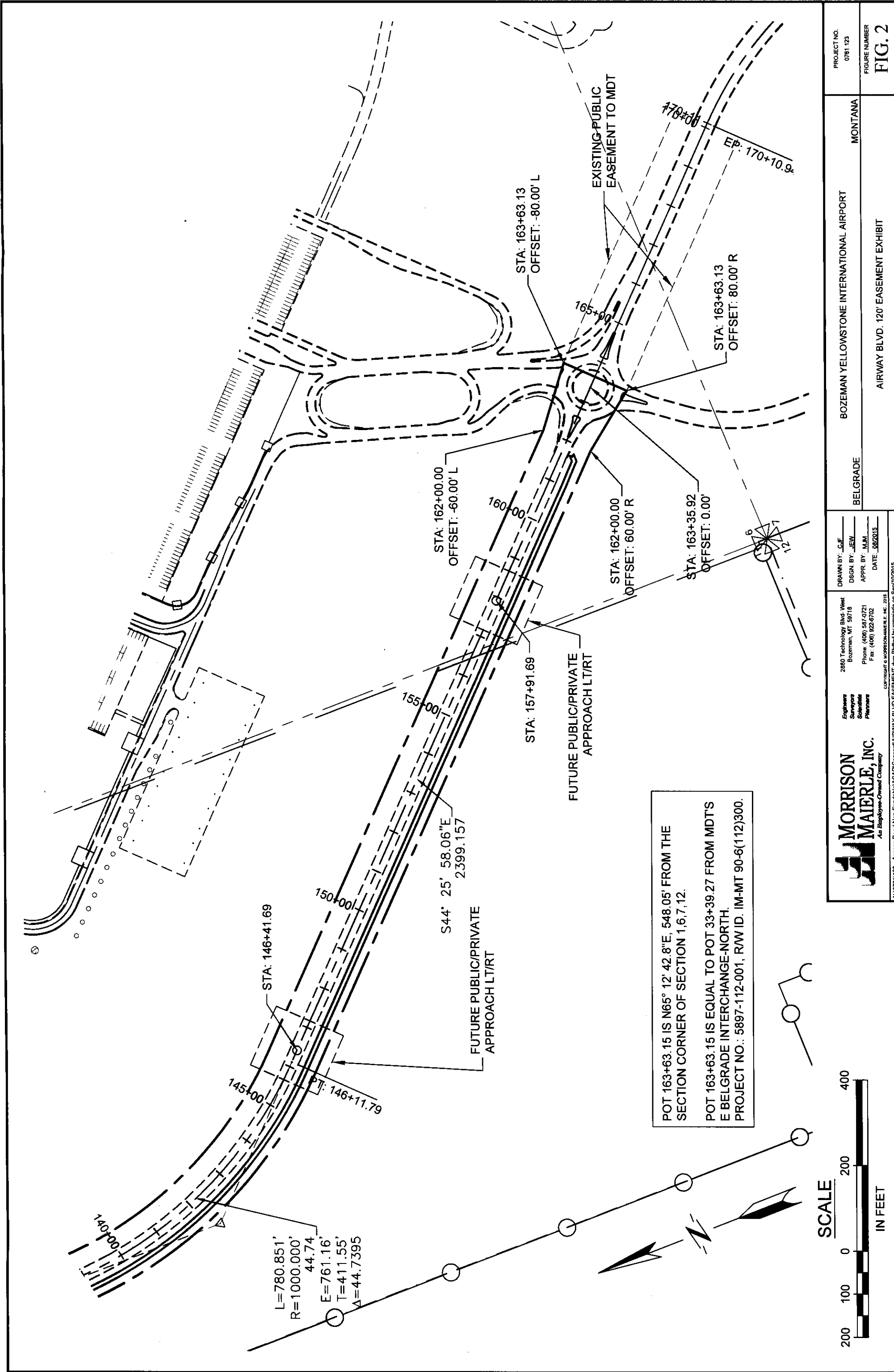

<b>MORRISON MAIERLE, INC.</b> <small>An Employee-Owned Company</small>	2880 Technology Blvd. West Bozeman, MT 59718 Phone: (406) 587-0721 Fax: (406) 922-6702	ENGINEER SURVEYOR SCHEMATIC DESIGNER PLANNER	BOZEMAN YELLOWSTONE INTERNATIONAL AIRPORT	PROJECT NO. 0781.123
	DRAWN BY: G.F. DSGN BY: J.E.W. APPR BY: M.M. DATE: 08/20/15		MONTANA	FIGURE NUMBER FIG. 2
AIRWAY BLVD. 120' EASEMENT EXHIBIT				

Copyright © Morrison Maierle, Inc. 2015  
N:\0781123 - Access Road Non-Fundable\ACAD\Concept\AIRWAY BLVD EASEMENT.dwg Plotted by mmale on Sep/10/2015