

THIS PROJECT

MONTANA DEPARTMENT OF TRANSPORTATION

STATE	RIGHT OF WAY	SHEET NO.	TOTAL SHEETS
MONTANA		1	2
R/W ID.	STPB 81-1(34)23		
PROJECT NO.	9342-034-001		

MT-81 BRIDGES

RIGHT OF WAY PLAN

FEDERAL AID PROJECT STPB 81-1(34)23

MT-81 BRIDGES

FERGUS COUNTY

LENGTH N/A MILES

PLAN LEGEND

PROPOSED RIGHT OF WAY LINE	---
EXISTING RIGHT OF WAY LINE	----
RAILROAD RIGHT OF WAY LINE	----
RIGHT OF WAY BASELINE	---
STK'D CENTERLINE	---
SECTION LINE	---
OWNERSHIP BOUNDARY	----
FULL ACCESS CONTROL	AC AC
LIMITED ACCESS CONTROL	///
EXISTING FULL ACCESS CONTROL	//// EFAC
EXISTING LIMITED ACCESS CONTROL	//// ELAC
PRESENT TRAVELED WAY (P.T.W.)	---
FENCE LINE	-x-x-
EXISTING GUARDRAIL	—•••••—
PROPOSED GUARDRAIL	—•••••—
GATE IN FENCE	-x-x-
CATTLE GUARD: EXIST. - PROPOSED	—•••••—
SECTION CORNER	FOUND UNFOUND
1/4 SECTION CORNER	FOUND UNFOUND
CLOSING CORNER	FOUND UNFOUND
MEANDER CORNER	FOUND UNFOUND
CENTER OF SECTION	FOUND UNFOUND
1/16 SECTION CORNER FOUND	FOUND UNFOUND
RIGHT OF WAY MONUMENT	FOUND CALCULATED
PROPERTY CORNER PIN	FOUND UNFOUND
POWER POLE IN PLACE	FOUND UNFOUND
TELEPHONE POLE IN PLACE	FOUND UNFOUND
TELEGRAPH POLE IN PLACE	FOUND UNFOUND
LIGHT POLE	FOUND UNFOUND
PROPOSED CULVERT	---
EXISTING CULVERT	---
OUTLET DITCH	---
INLET DITCH	---
EXISTING DITCH	---
CHANNEL CHANGES	CH CH
DITCH BLOCK	---
RIPRAP	---
BRIDGES	---
RAILROADS	---
PARCEL NUMBERS	②
APPROACH: EXIST. - PROPOSED	---



ASSOCIATED PROJECTS
STPB 81-1(33)23 PE

RELATED PROJECTS
BH 0002(794)
RS 342(9)
S 342(4)
S 342(6)

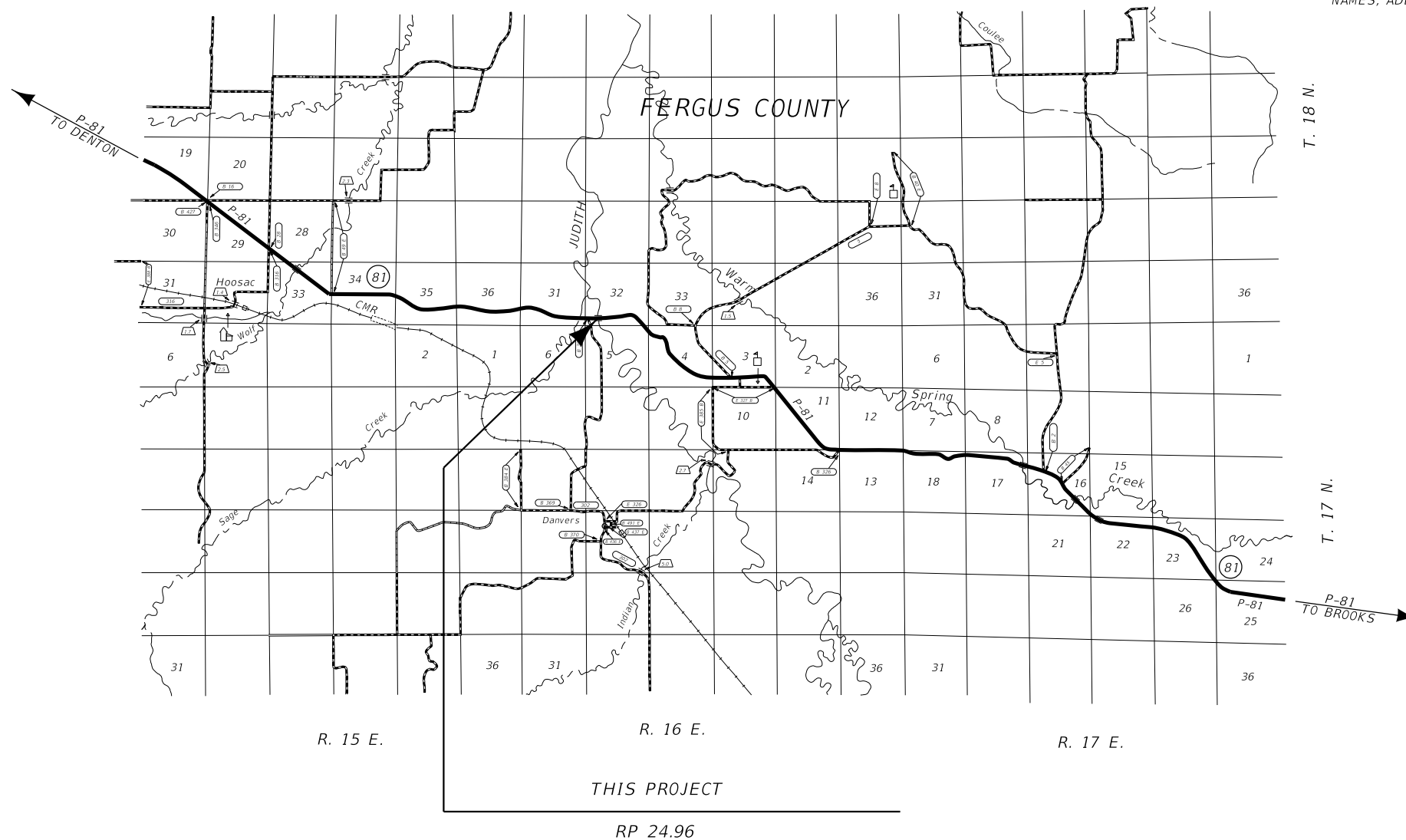

SEE SHEET NO. 2 FOR OWNERSHIP NAMES, ADDRESSES, AREAS, ETC.

CONSTRUCTION LIMITS



MAP REVISED	_____
FHWA/MDT APPROVAL	5-11-20

OWNERSHIP

PARCEL	NAME	ADDRESS	TOTAL AREA	GROSS R/W AREA	EX. EASE. AREA	NET AREA	CONST. PMT. AREA	EASEMENT AREA	SHEET NO.
1	QUASAR & INFINITY THOMSON	PO BOX 7, DENTON, MT 59430	160+ AC				0.44 AC		2

STATE	RIGHT OF WAY	SHEET NO.	TOTAL SHEETS
MONTANA		2	2
R/W ID.	STPB 81-1(34)23		
PROJECT NO.	9342-034-001		

MT-81 BRIDGES



CONSTRUCTION LIMITS	MAP REVISED
CUT SECTION	TOP OF CUT
TOE OF FILL	
FHWA/MDT APPROVAL 5-11-20	
3	C:\DGN\9342001\ropln001.dgn
2	MDT MONTANA DEPARTMENT OF TRANSPORTATION 5/12/2020
1	10:57:22 AM CPS - U1068

- NOTES:
1. THE PROPOSED R/W LINE WHERE A SPIRAL CURVE TRANSITION IS USED IS A CHORD RATHER THAN A CONCENTRIC CURVE.
 2. ALL STATIONS AND OFFSETS FOR R/W BREAKS ARE IN REFERENCE TO THE R/W BASELINE.

MONTANA DEPARTMENT OF TRANSPORTATION
RIGHT OF WAY PLAN
 FERGUS COUNTY
 NOT TO SCALE