

PLANS
NOT
TO
SCALE

State

DEPARTMENT OF THE INTERIOR
Bureau of Land Management
Montana Land Office
Billings, Montana

I hereby certify that the gravelpit represented hereon by cross-hatching affects:

E¹NE¹SW¹SE¹NE¹ Section 8, T 32 N, R 2 W
E¹SE¹NW¹SE¹NE¹ Section 8, T 32 N, R 2 W
E¹SE¹NE¹ " " " "

which is unappropriated and unreserved public land.

January 31, 1950
Date

William Riddell
William Riddell, Manager.

FED. ROAD DIST. NO.	STATE	FED. AID PROJ. NO.	SHEET No.	TOTAL SHEETS
1	MONT.	243 A	1	1

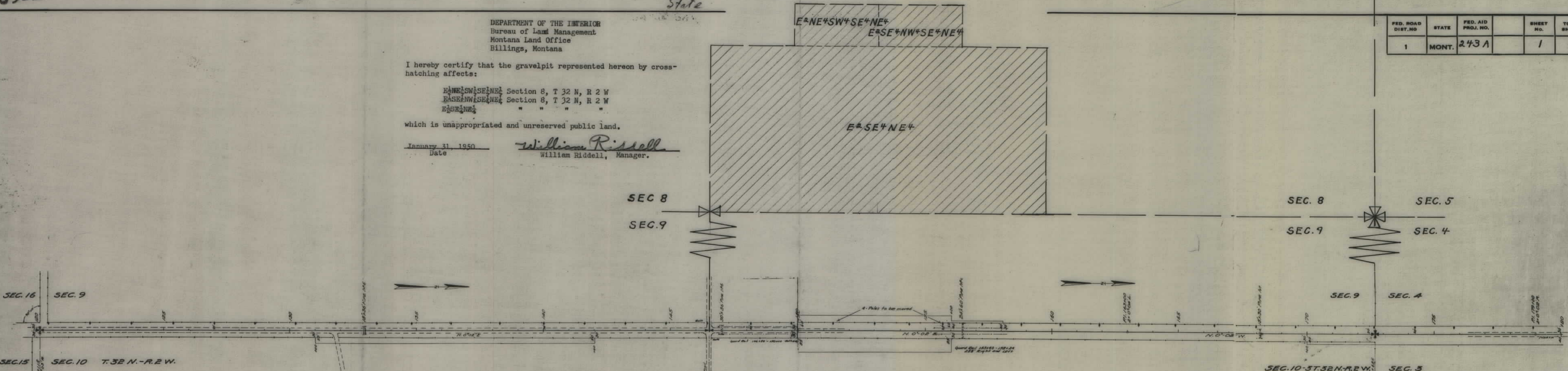

STATE OF MONTANA
STATE HIGHWAY COMMISSION
PLAT SHOWING LAND
REQUIRED FOR RIGHT OF WAY
TOOLE COUNTY

SCALE 1"= 200' MAP COMPLETED DEC. 17 1949

DESCRIPTIONS WRITTEN BY _____ DATE _____

DESCRIPTIONS CHECKED BY _____ DATE _____

APPROVED BY _____ PLANS DEPT.

APPROVED BY _____ R/W ENGINEER