

# MONTANA DEPARTMENT OF TRANSPORTATION

STATE	RIGHT OF WAY ID.	SHEET	TOTAL
		NO.	SHEETS
MONTANA	NH 1-7(36)401	1	2
PROJECT NUMBER 4951-036			
RW AQUIS-2 M W OF CHINOOK			

## RIGHT OF WAY PLAN OF FEDERAL AID PROJECT NH 1-7(36)401 RW AQUIS-2 M W OF CHINOOK BLAINE COUNTY

n/a Kilometers

### CONVENTIONAL SIGNS

PROPOSED RIGHT OF WAY LINE	---
EXISTING RIGHT OF WAY LINE	---
RAILROAD RIGHT OF WAY LINE	---
RIGHT OF WAY BASELINE	---
STK'D CENTERLINE	---
SECTION LINE	---
OWNERSHIP BOUNDARY	---
FULL ACCESS CONTROL	AC AC
LIMITED ACCESS CONTROL	/// ///
EXISTING ACCESS CONTROL	/// ///
PRESENT TRAVELED WAY (P.T.W.)	---
FENCE LINE	x x x x
EXISTING GUARDRAIL	-   -   -   -
PROPOSED GUARDRAIL	-   -   -   -
GATE IN FENCE	x x x x
CATTLE GUARD: EXIST. - PROPOSED	--- --
SECTION CORNER	FOUND  UNFOUND
1/4 SECTION CORNER	FOUND  UNFOUND
CLOSING CORNER	FOUND  UNFOUND
MEANDER CORNER	FOUND  UNFOUND
CENTER OF SECTION	FOUND  UNFOUND
RIGHT OF WAY MONUMENT	FOUND  CALCULATED
PROPERTY CORNER PIN	
POWER POLE IN PLACE	
TELEPHONE POLE IN PLACE	
TELEGRAPH POLE IN PLACE	
LIGHT POLE	
PROPOSED CULVERT	==
EXISTING CULVERT	==
OUTLET DITCH	==
INLET DITCH	==
EXISTING DITCH	==
CHANNEL CHANGES	CH. CH. 2
DITCH BLOCK	88
RIPRAP	88
BRIDGES	==
RAILROADS	==
PARCEL NUMBERS	2
APPROACH: EXIST.- PROPOSED	---

ASSOCIATED PROJECT ID.

RELATED PROJECTS
FAP 66

FWHAMDT APPROVAL	1-16-07
MAP REVISED	

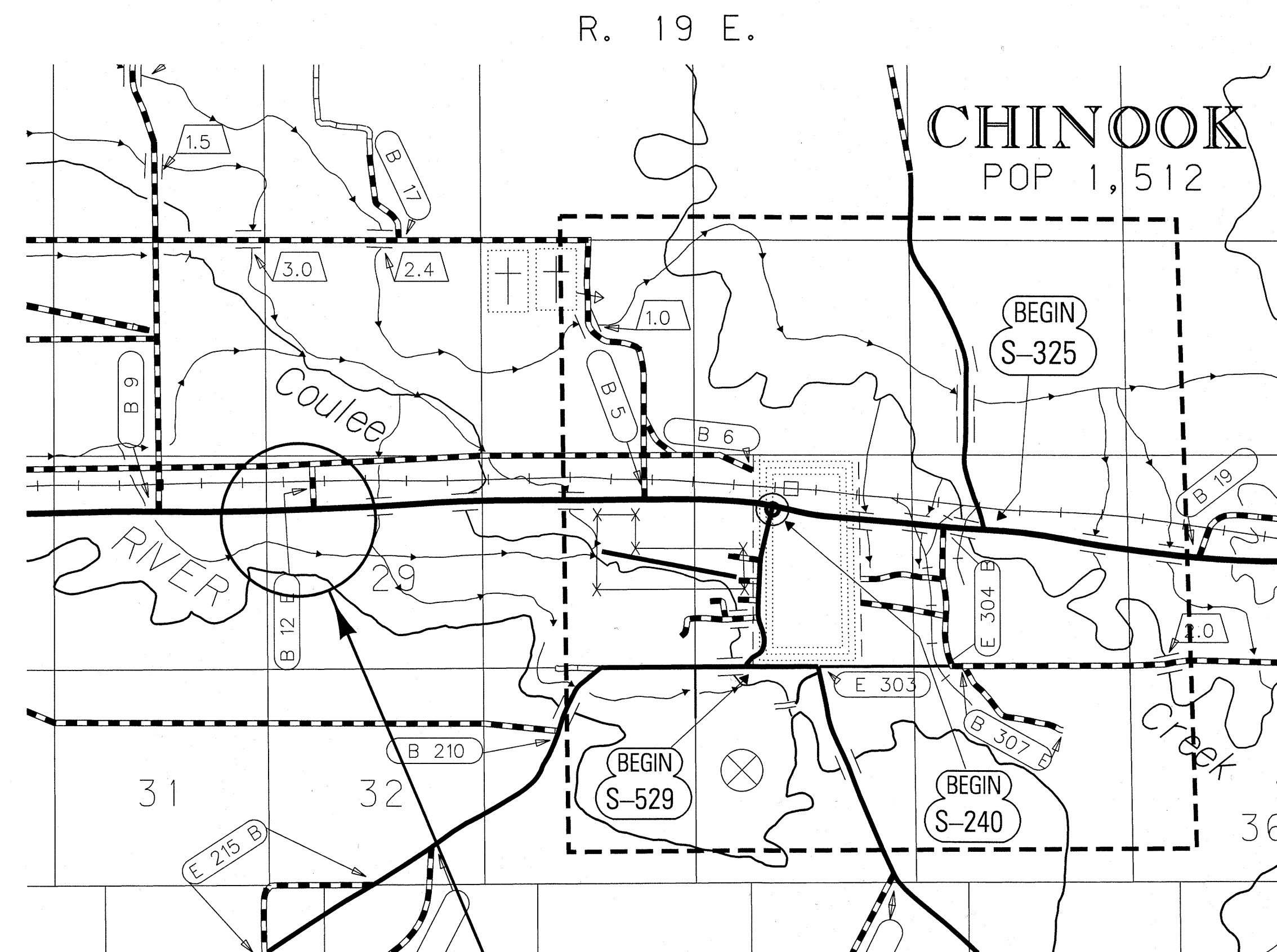

SEE SHEET NO. 2 FOR OWNERSHIP  
NAMES, ADDRESSES, AREAS, ETC.

ACQUISITION  
AREA

NOTES: 1. ALL MEASUREMENTS ARE METRIC EXCEPT AS NOTED

