

MONTANA DEPARTMENT OF TRANSPORTATION

STATE	RIGHT OF WAY	SHEET	TOTAL
		NO.	SHEETS
MONTANA		1	4
R/W ID.		NH 5-3(148)113	
PROJECT NO.		9031-148-000	

US 93-IDAHO TO GRANDVIEW (KAL)

RIGHT OF WAY PLAN FEDERAL AID PROJECT NH 5-3(148)113 US 93-IDAHO TO GRANDVIEW (KAL) FLATHEAD COUNTY

LENGTH 1.9 MILES

SEE SHEET NO. 2 FOR OWNERSHIP
NAMES, ADDRESSES, AREAS, ETC.

PLAN LEGEND

PROPOSED RIGHT OF WAY LINE	---
EXISTING RIGHT OF WAY LINE	---
RAILROAD RIGHT OF WAY LINE	---
RIGHT OF WAY BASELINE	---
STK'D CENTERLINE	---
SECTION LINE	---
OWNERSHIP BOUNDARY	---
FULL ACCESS CONTROL	AC AC
LIMITED ACCESS CONTROL	/// ///
EXISTING FULL ACCESS CONTROL	EFAC EFAC
EXISTING LIMITED ACCESS CONTROL	ELAC ELAC
PRESENT TRAVELED WAY (P.T.W.)	---
FENCE LINE	---
EXISTING GUARDRAIL	- - - -
PROPOSED GUARDRAIL	- - - -
GATE IN FENCE	---
CATTLE GUARD: EXIST. - PROPOSED	---
SECTION CORNER	FOUND UNFOUND
1/4 SECTION CORNER	---
CLOSING CORNER	---
MEANDER CORNER	---
CENTER OF SECTION	---
1/16 SECTION CORNER FOUND	---
RIGHT OF WAY MONUMENT	FOUND CALCULATED
PROPERTY CORNER PIN	---
POWER POLE IN PLACE	---
TELEPHONE POLE IN PLACE	---
TELEGRAPH POLE IN PLACE	---
LIGHT POLE	---
PROPOSED CULVERT	---
EXISTING CULVERT	---
OUTLET DITCH	---
INLET DITCH	---
EXISTING DITCH	---
CHANNEL CHANGES	CH. CH.
DITCH BLOCK	---
RIPRAP	---
BRIDGES	---
RAILROADS	---
PARCEL NUMBERS	---
APPROACH: EXIST.- PROPOSED	---



ASSOCIATED PROJECTS

NH 5-3(137)113 P.E.

RELATED PROJECTS

F 270-A
F 270(6)

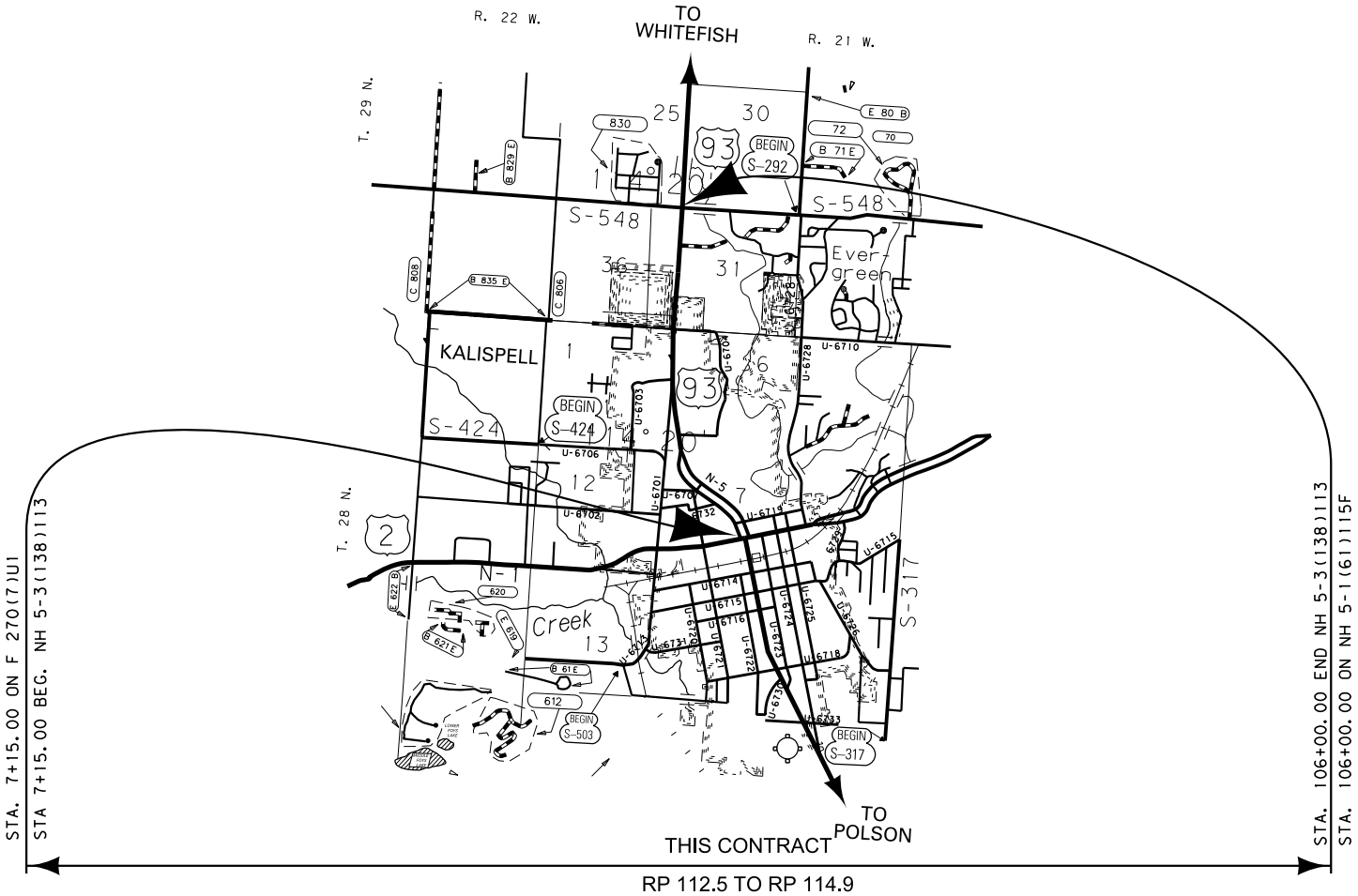

FOR EXISTING R/W RETRACEMENT, SEE
C.O.S. NO. 20560

GRID STATE PLANE COORDINATES

THIS IS A STATE PLANE COORDINATE PROJECT. ALL
DIMENSIONS, DISTANCES AND AREAS ON THIS PROJECT
ARE GRID, EXCEPT FOR THE EXISTING R/W WIDTH
DIMENSION, WHICH IS RECORD.
THE COMBINATION SCALE FACTOR IS 0.99947141

CONSTRUCTION LIMITS

CUT SECTION
TOE OF FILL

MAP REVISED

02-02-18

STATE	RIGHT OF WAY	SHEET	TOTAL
		NO.	SHEETS
MONTANA		4	4
R/W ID.		NH 5-3(148)113	
PROJECT NO.		9031-148-000	

US 93-IDAHO TO GRANDVIEW (KAL)

N. MAIN ST.

SEE SHEET NO. 2 FOR OWNERSHIP NAMES, ADDRESSES, AREAS, ETC.

T. 28 N. R. 21 W.

SW⁴ NW⁴
SEC. 7

C.O.S. 15550
TRACT 2

US HWY 93

MAIN ST & HWY 93
DETAIL

STA 15+93.66 IS S 10 ° 24' 50"E
226.54' FROM THE CENTER OF MAIN
STREET AND NEVADA STREET.

CONSTRUCTION LIMITS

CUT SECTION

TRANSITION

TOE OF FILL

MAP REVISED 6-21-18

FHWA/MDT APPROVAL

02-02-18

3

2

1

MDT

MONTANA DEPARTMENT OF TRANSPORTATION

C:\DGN\9031000\rodel004.dgn

8/10/2018

1:40:38 PM

CPS - U1757

- NOTES:
1. THE PROPOSED R/W LINE WHERE A SPIRAL CURVE TRANSITION IS USED IS A CHORD RATHER THAN A CONCENTRIC CURVE.
 2. ALL STATIONS AND OFFSETS FOR R/W BREAKS ARE IN REFERENCE TO THE R/W BASELINE.

FOR EXISTING R/W RETRACEMENT, SEE
C.O.S. NO. 20560

GRID STATE PLANE COORDINATES
THIS IS A STATE PLANE COORDINATE PROJECT. ALL
DIMENSIONS, DISTANCES AND AREAS ON THIS PROJECT
ARE GRID, EXCEPT FOR THE EXISTING R/W WIDTH
DIMENSION, WHICH IS RECORD.
THE COMBINATION SCALE FACTOR IS 0.99947141

MONTANA DEPARTMENT OF TRANSPORTATION
RIGHT OF WAY PLAN
FLATHEAD COUNTY
NOT TO SCALE