

PLANS
NOT
TO
SCALE

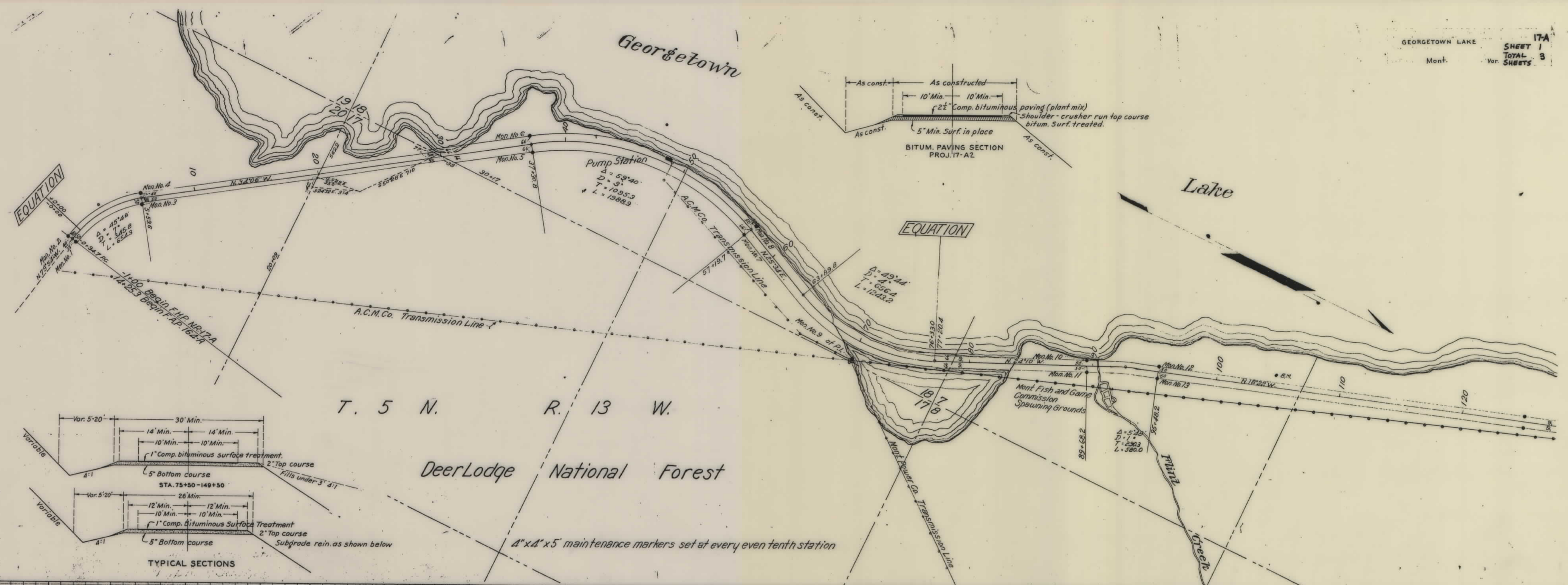

T. 5 N. R. 13 W.

DeerLodge National Forest

4" x 4" x 5" maintenance markers set at every even tenth station

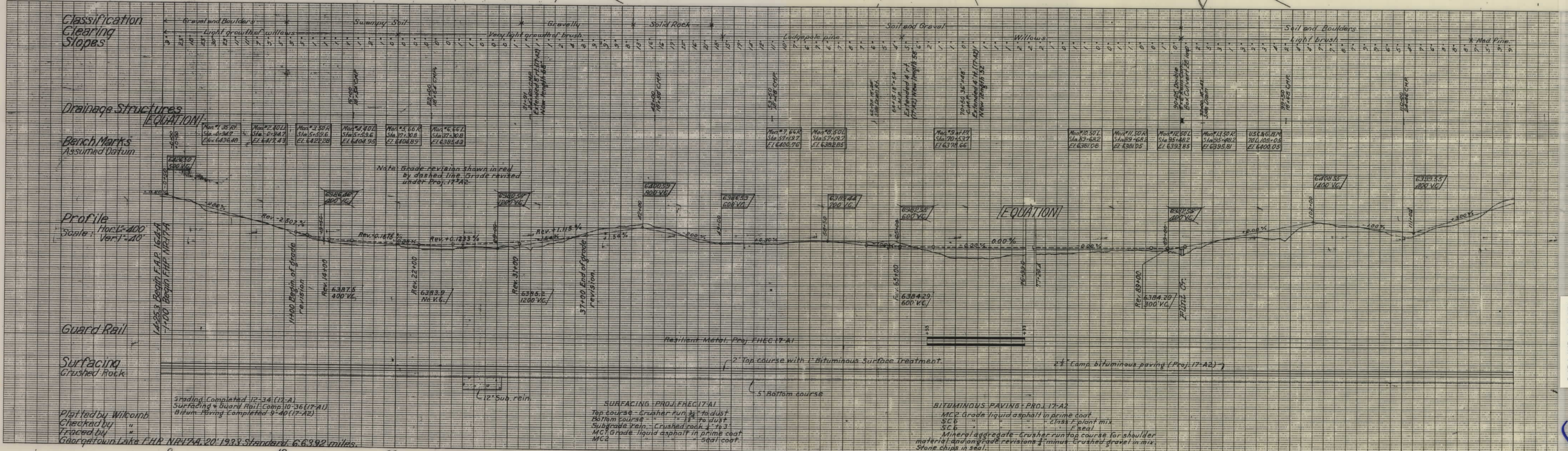

grading Completed 12-34 (17-A)
Surfacing + Guard Rail Comp. 10-36 (17-A1)
Bitum. Paving Completed 9-40 (17-A2)

Plotted by Wilcomb
Checked by "
Fraced by "
Georgetown Lake F.H.R. NR-17A, 20' 1933 Standard, 6.6392 miles.

SURFACING PROJ. FHCC 17-A1
Top course - Crusher run 3/4" to dust
Bottom course - " 1/2" to dust
Subgrade rein. - Crushed rock 2" to 3"
M.C.I. Grade liquid asphalt in prime coat
M.C.I. seal coat

BITUMINOUS PAVING PROJ. 17-A2
M.C.I. Grade liquid asphalt in prime coat
S.C.6 " 2" Class F plant mix
S.C.6 " F seal
Mineral aggregate - Crusher run top course for shoulder material and on grade revisions 3/4" minus - Crushed gravel in mix
Stone chips in seal.

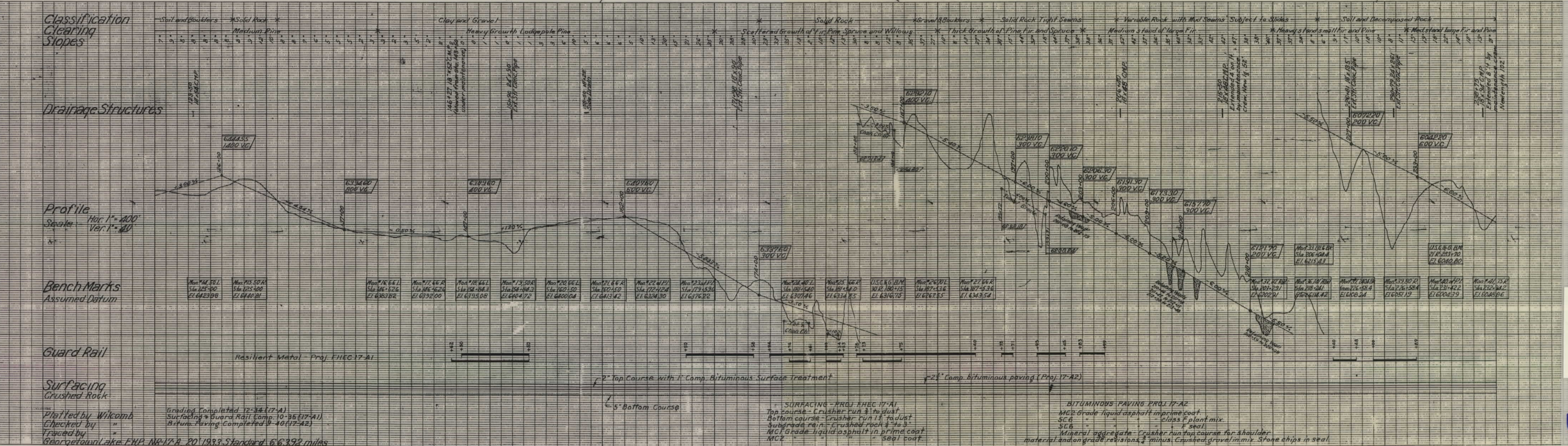
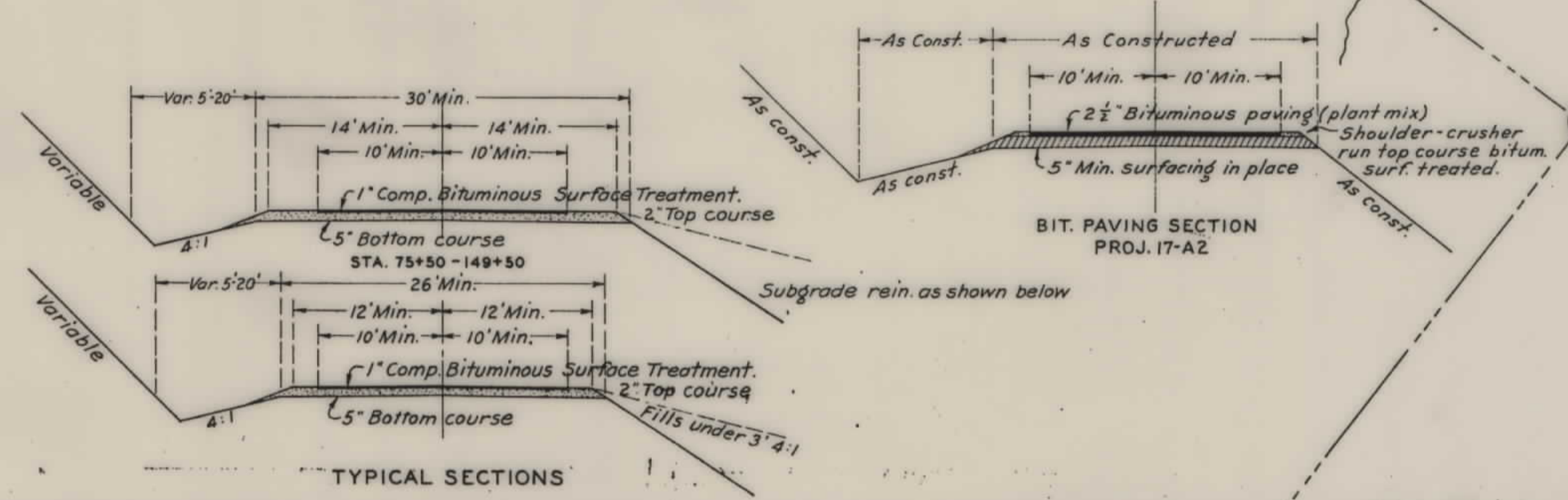
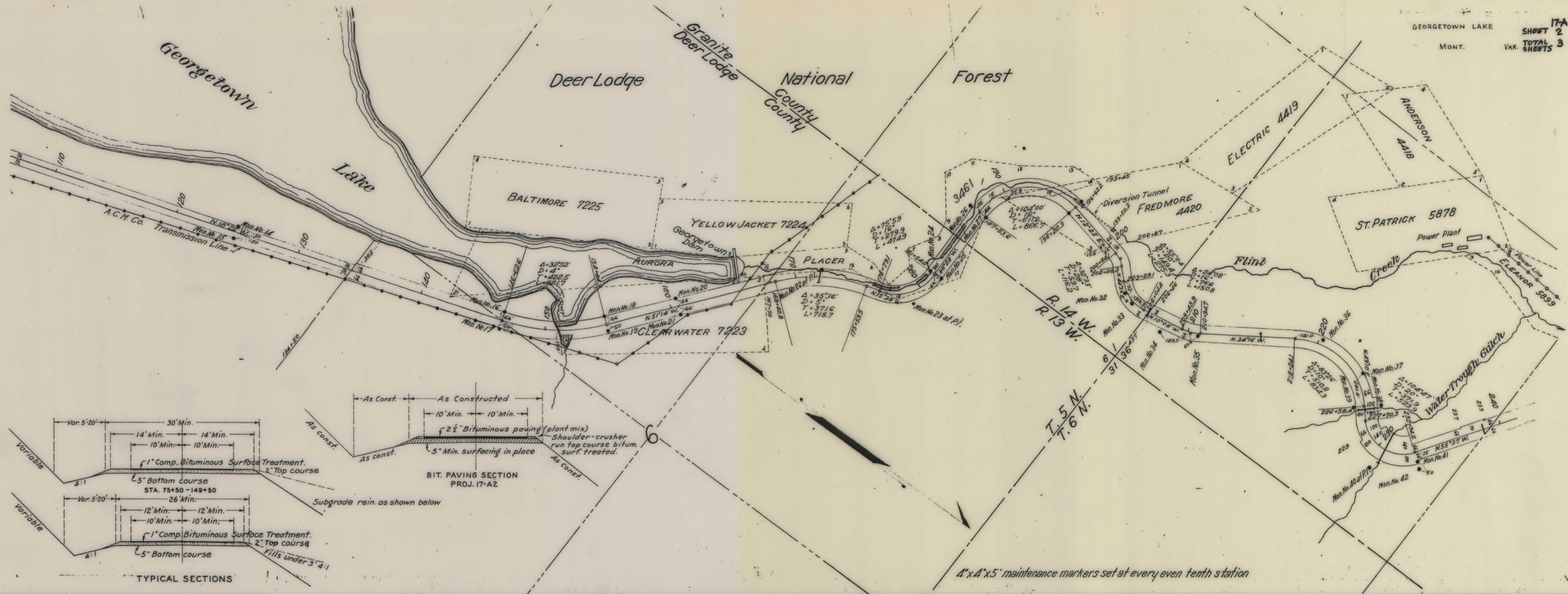

Deer Lodge National Forest

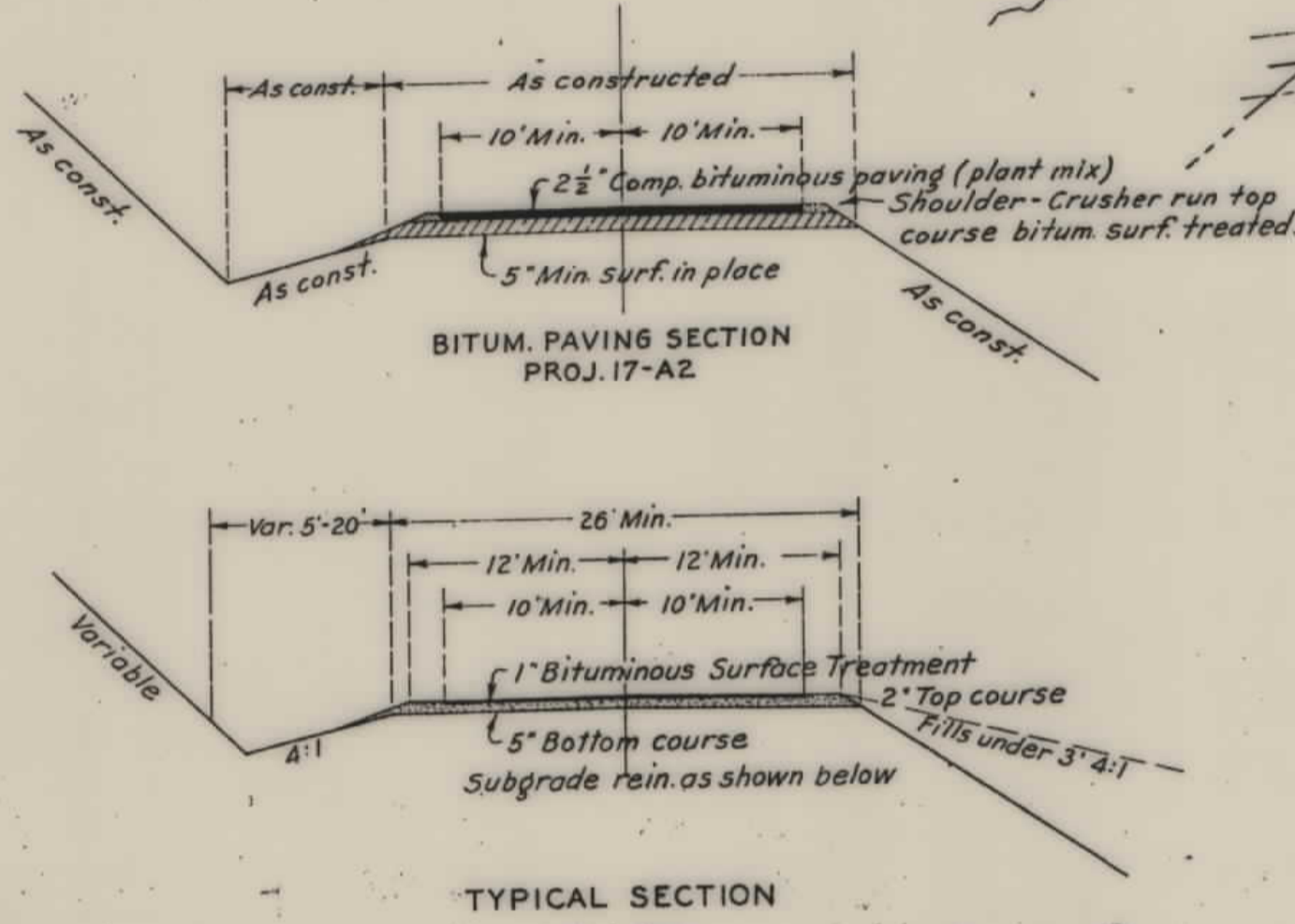
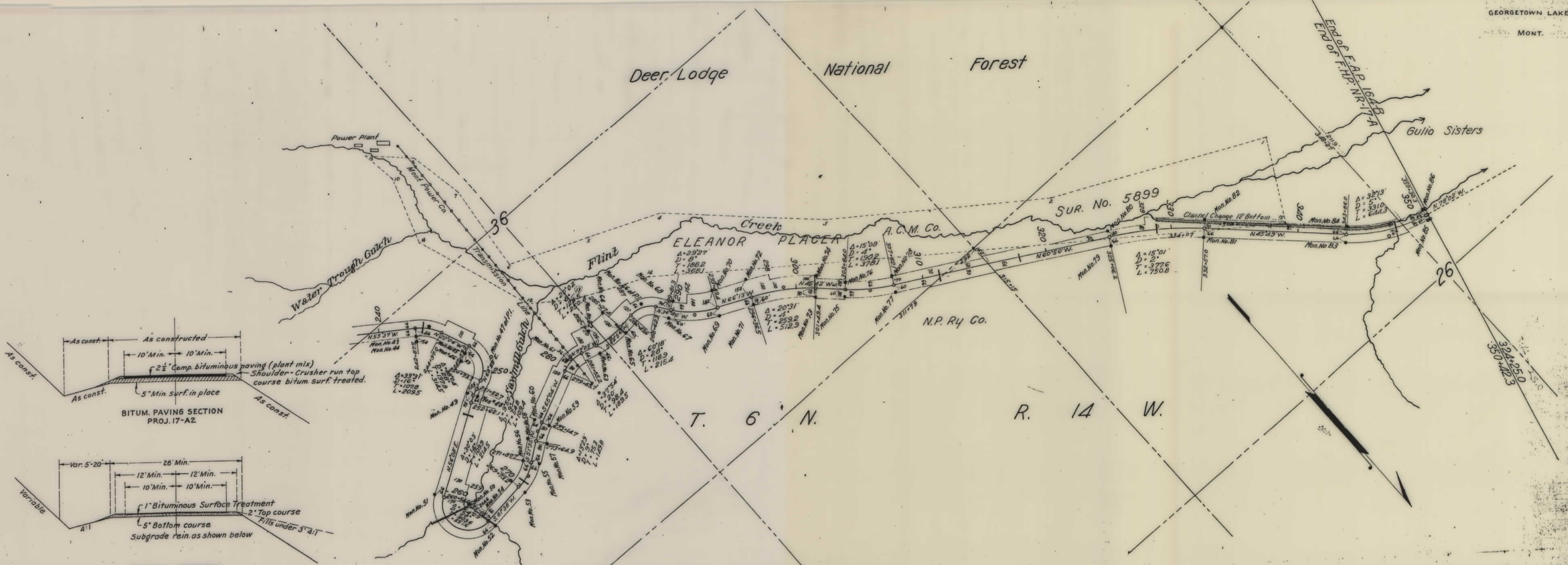

4'x4'x5' maintenance markers set at every even tenth station

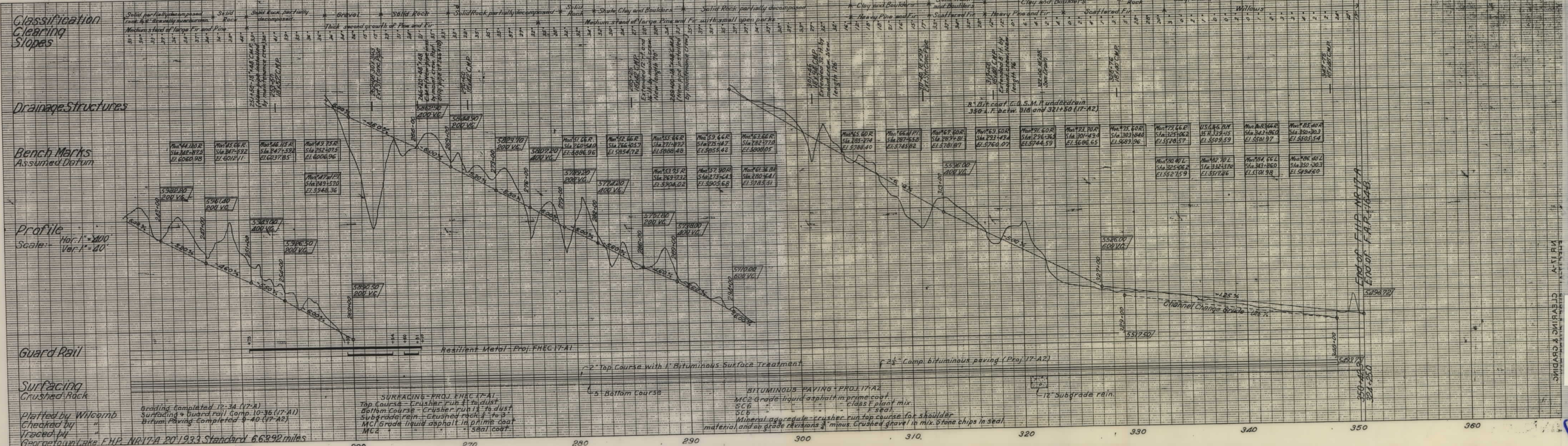

Classification Clearing Slopes
Drainage Structures
Bench Marks Assumed Datum
Profile
 Hor. 1" = 100'
 Scale: Var. 1" = 40'
Guard Rail
Surfacing
 Crushed Rock

Platted by Wilcomb
 Checked by
 Traced by
 Georgetown Lake F.H.P. NR-17A 201933 Standard 66392 miles

SURFACING - PROJ. EHEC 17-A1
 Top Course - Crusher run 1 1/2" to dust
 Bottom Course - Crusher run 1 1/2" to dust
 Subgrade Rein. - Crushed rock 1 1/2" to 3"
 M.C.G. Grade liquid asphalt in prime coat
 Seal coat

BITUMINOUS PAVING - PROJ. 17-A2
 M.C.G. Grade liquid asphalt in prime coat
 S.C.B. class F plant mix
 S.C.B. F seal
 Mineral aggregate - crusher run top course for shoulder material and on grade elevations 3/4" minus. Crushed gravel in mix. Stone chips in seal