

PLANS

NOT

TO

SCALE

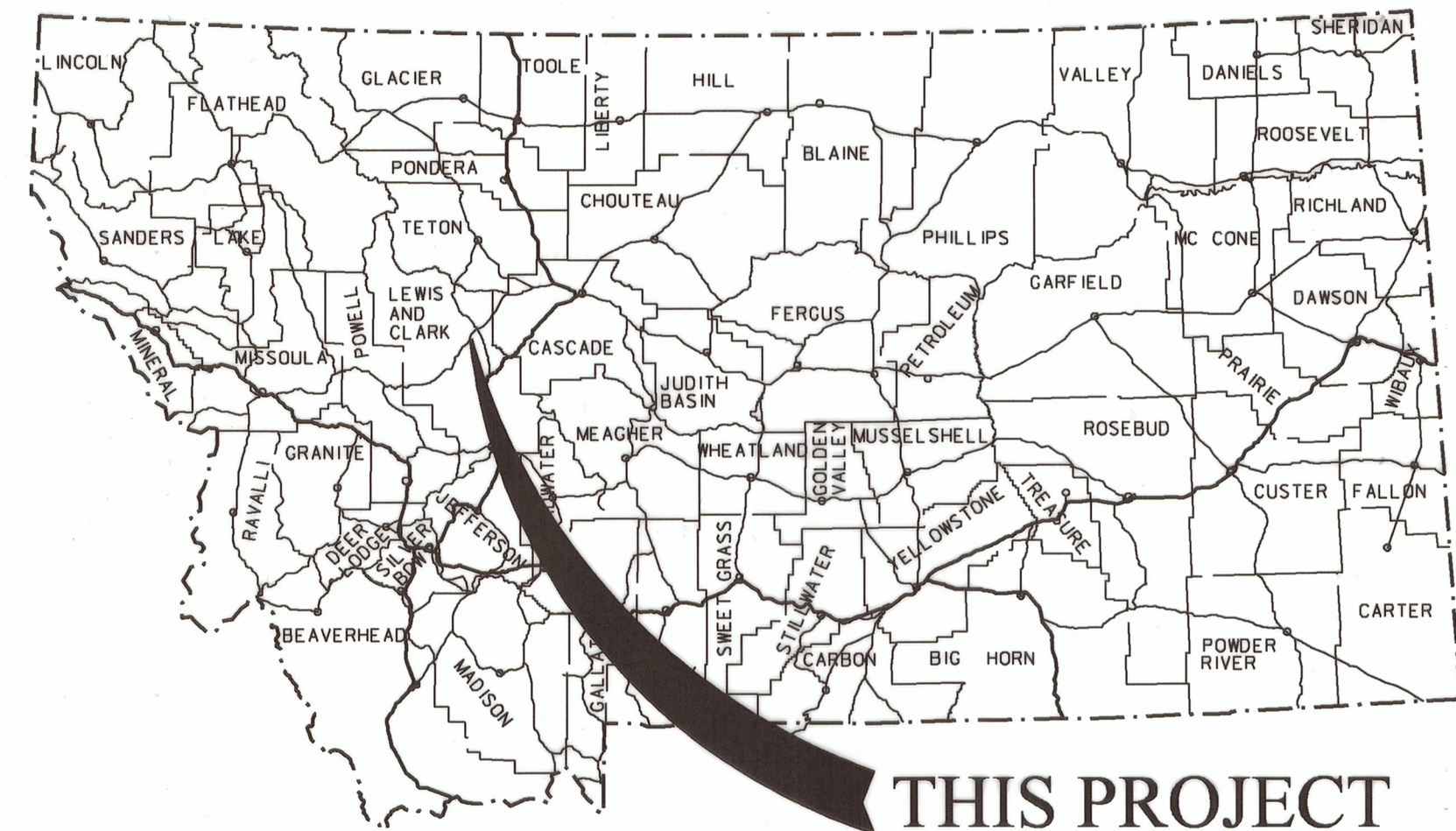

MONTANA DEPARTMENT OF TRANSPORTATION

STATE	RIGHT OF WAY	SHEET TOTAL	
		NO.	SHEETS
MONTANA		1	2
R/W ID.		NH 24-3(39)100	
PROJECT NO.		6440-039-000	

CULVERT-NE OF ROGERS PASS

RIGHT OF WAY PLAN FEDERAL AID PROJECT NH 24-3(39)100 CULVERT-NE OF ROGERS PASS LEWIS AND CLARK COUNTY

LENGTH N/A MILES

SEE SHEET NO. 2 FOR OWNERSHIP
NAMES, ADDRESSES, AREAS, ETC.

PLAN LEGEND

PROPOSED RIGHT OF WAY LINE	---
EXISTING RIGHT OF WAY LINE	---
RAILROAD RIGHT OF WAY LINE	---
RIGHT OF WAY BASELINE	---
STK'D CENTERLINE	---
SECTION LINE	---
OWNERSHIP BOUNDARY	---
FULL ACCESS CONTROL	AC AC
LIMITED ACCESS CONTROL	---
EXISTING ACCESS CONTROL	---
PRESENT TRAVELED WAY (P.T.W.)	---
FENCE LINE	---
EXISTING GUARDRAIL	---
PROPOSED GUARDRAIL	---
GATE IN FENCE	---
CATTLE GUARD: EXIST. - PROPOSED	---
SECTION CORNER	FOUND UNFOUND
1/4 SECTION CORNER	---
CLOSING CORNER	---
MEANDER CORNER	---
CENTER OF SECTION	---
1/16 SECTION CORNER FOUND	---
RIGHT OF WAY MONUMENT	FOUND CALCULATED
PROPERTY CORNER PIN	---
POWER POLE IN PLACE	---
TELEPHONE POLE IN PLACE	---
TELEGRAPH POLE IN PLACE	---
LIGHT POLE	---
PROPOSED CULVERT	---
EXISTING CULVERT	---
OUTLET DITCH	---
INLET DITCH	---
EXISTING DITCH	---
CHANNEL CHANGES	CH. CH. 2'
DITCH BLOCK	---
RIPRAP	---
BRIDGES	---
RAILROADS	---
PARCEL NUMBERS	---
APPROACH: EXIST.-PROPOSED	---



ASSOCIATED PROJECTS
NH 24-3(35)100 PE

RELATED PROJECTS
F 24-3(16)91 F 50B(1) F 50(7)

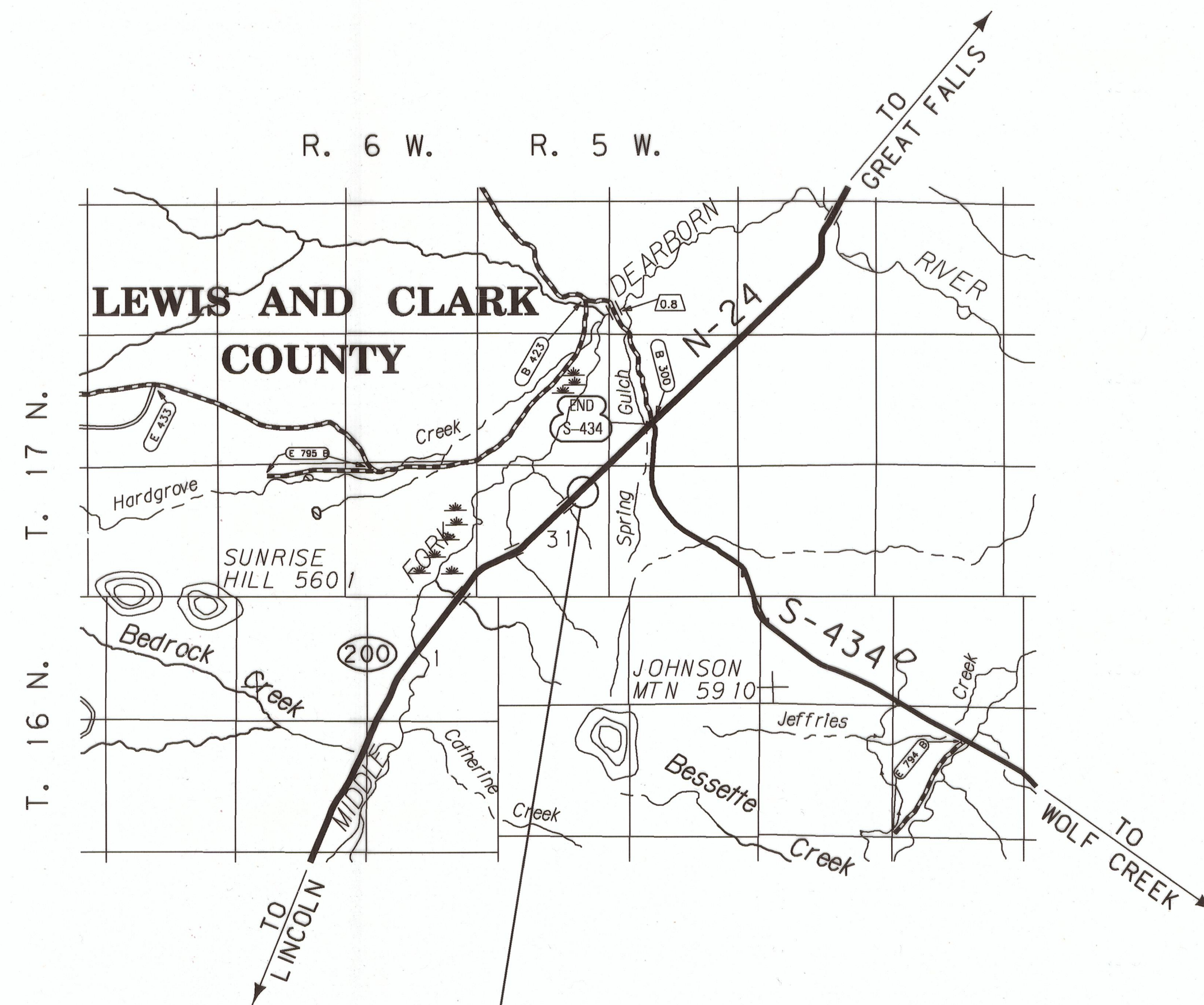

THIS CONTRACT
STA 39+70.00 =
STA 940+60 ON NH 24-3(21)91
R.P. 99.534

CONSTRUCTION LIMITS		MAP REVISED	
CUT SECTION	TOP OF CUT		
TRANSITION			
TOE OF FILL			
BACKSLOPE LIMITS			
INCLUDE ROUNDING			
FHWA/MDT APPROVAL		2-1-10	
3	MONTANA DEPARTMENT OF TRANSPORTATION	c:\dgn\6440000\rot1001.dgn	
2	MDT	2/11/2010	
		8:18:05 AM	CPS - U1068

GRID STATE PLANE COORDINATES
THIS IS A STATE PLANE COORDINATE PROJECT. ALL
DIMENSIONS, DISTANCES AND AREAS ON THIS PROJECT
ARE GRID, EXCEPT FOR THE EXISTING R/W WIDTH
DIMENSION, WHICH IS RECORD.
THE COMBINATION SCALE FACTOR IS 0.99919105

