

**PLANS  
NOT  
TO  
SCALE**

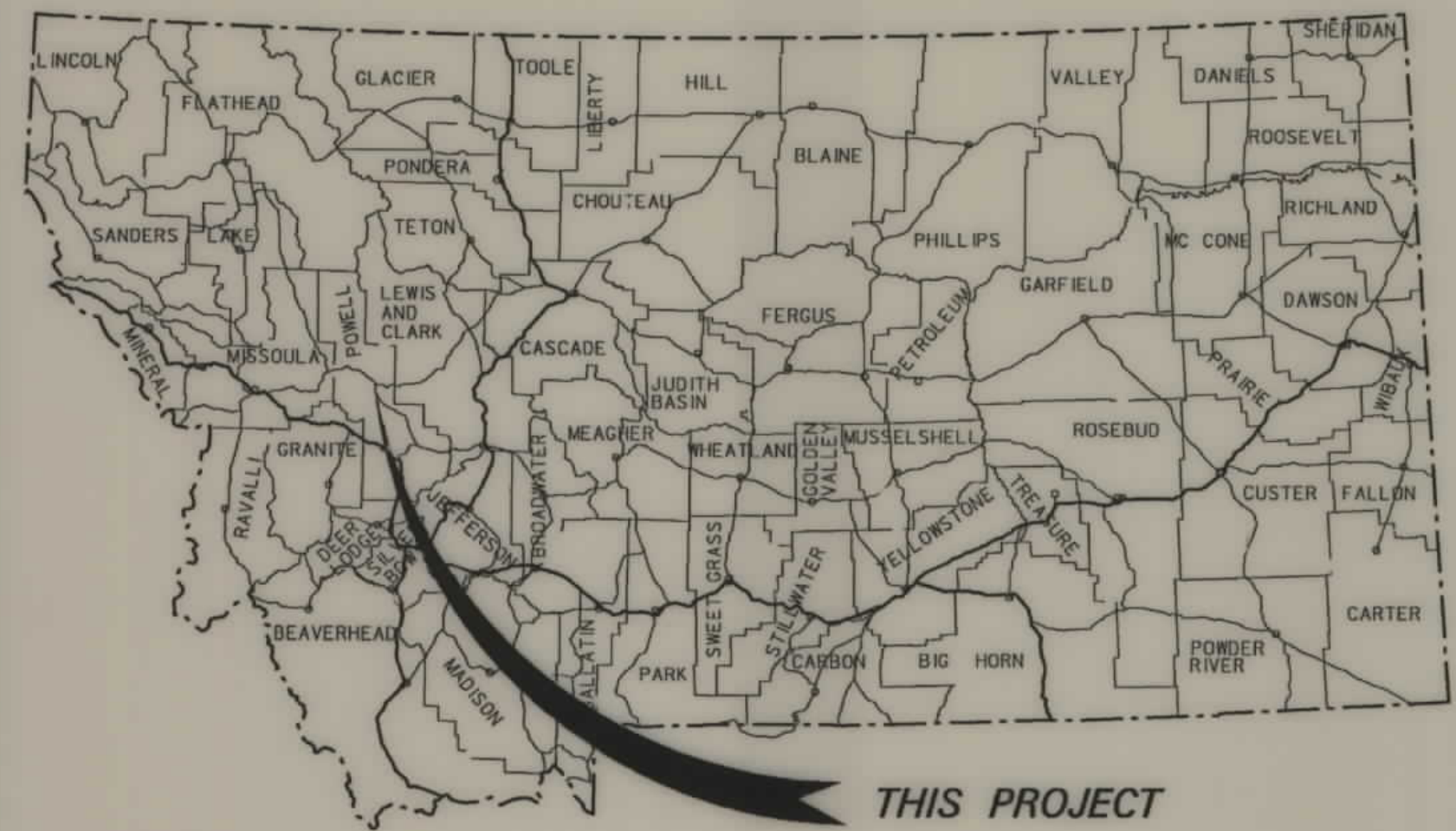



# MONTANA DEPARTMENT OF TRANSPORTATION

STATE	RIGHT OF WAY ID.	SHEET NO.	TOTAL SHEETS
MONTANA	IM 90-3(76)173	1	3
PROJECT NUMBER 3097-076			
GARRISON - BECK HILL (O'NEILL CREEK CROSSING)			

## RIGHT OF WAY PLAN OF FEDERAL AID PROJECT IM 90-3(76)173 GARRISON - BECK HILL (O'NEILL CREEK CROSSING) POWELL COUNTY

N/A Kilometers

CONVENTIONAL SIGNS	
PROPOSED RIGHT OF WAY LINE	---
EXISTING RIGHT OF WAY LINE	---
RAILROAD RIGHT OF WAY LINE	---
CENTERLINE (C) OR PROJECTED LINE	---
STK'D CENTERLINE	---
SECTION LINE	---
OWNERSHIP BOUNDARY	---
FULL ACCESS CONTROL	AG AG
LIMITED ACCESS CONTROL	/// ///
EXISTING ACCESS CONTROL	/// ///
PRESENT TRAVELED WAY (P.T.W.)	---
FENCE LINE	x-x-x-x
EXISTING GUARDRAIL	-  -  -  -
PROPOSED GUARDRAIL	-  -  -  -
GATE IN FENCE	x-x-x-x
CATTLE GUARD: EXIST. - PROPOSED	---x---x---
SECTION CORNER	FOUND UNFOUND
1/4 SECTION CORNER	FOUND UNFOUND
CLOSING CORNER	FOUND UNFOUND
MEANDER CORNER	FOUND UNFOUND
CENTER OF SECTION	FOUND UNFOUND
RIGHT OF WAY MONUMENT	FOUND UNFOUND
PROPERTY CORNER PIN	FOUND UNFOUND
POWER POLE IN PLACE	FOUND UNFOUND
TELEPHONE POLE IN PLACE	FOUND UNFOUND
TELEGRAPH POLE IN PLACE	FOUND UNFOUND
LIGHT POLE	FOUND UNFOUND
PROPOSED CULVERT	---
EXISTING CULVERT	---
OUTLET DITCH	---
INLET DITCH	---
EXISTING DITCH	---
CHANNEL CHANGES	CH. CH. -U-
DITCH BLOCK	---
RIPRAP	---
BRIDGES	---
RAILROADS	---
PARCEL NUMBERS	---
APPROACH: EXIST.- PROPOSED	---

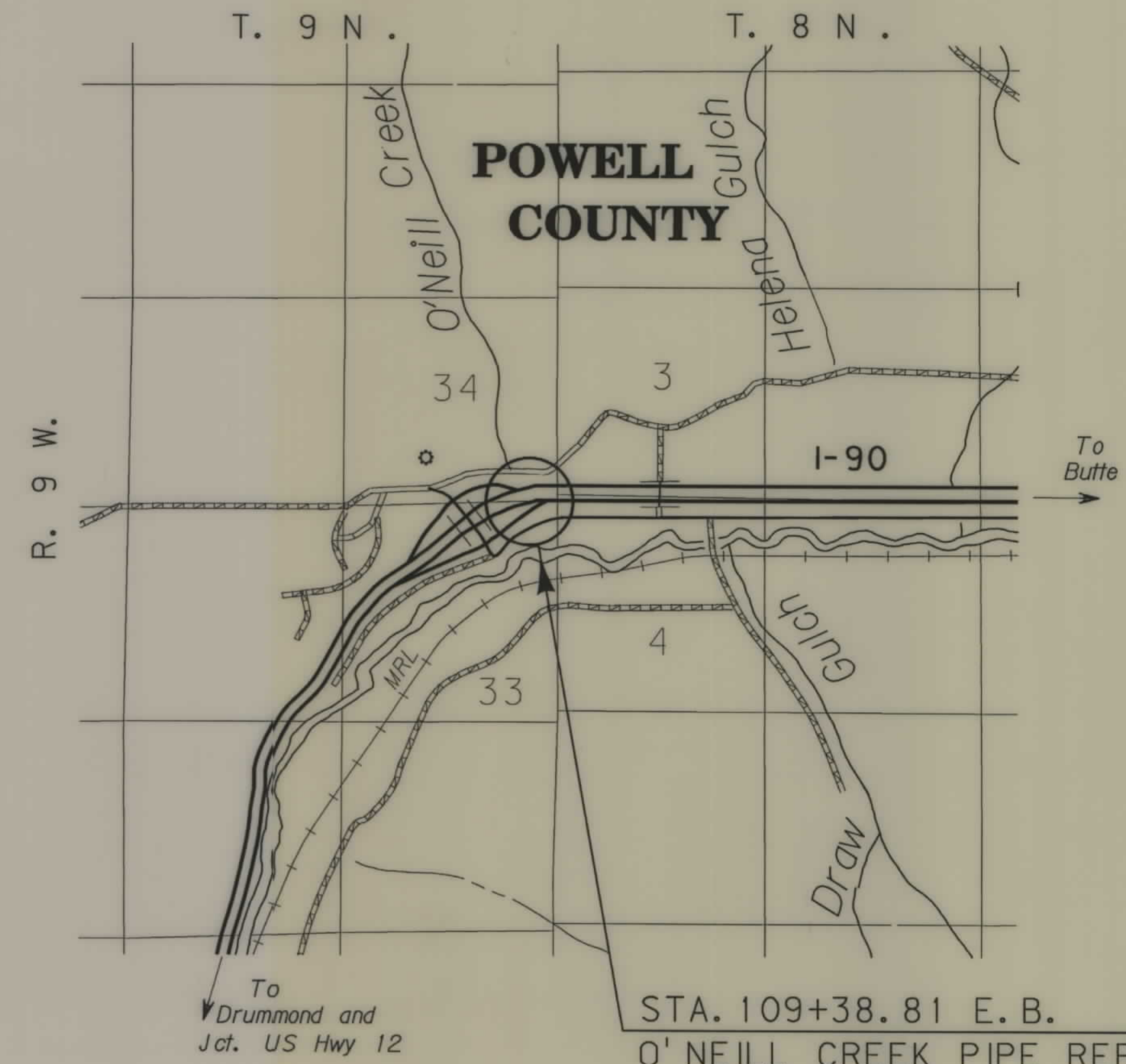
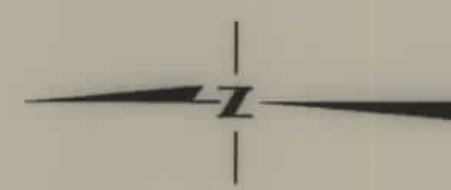

SEE SHEET NO. 3 FOR OWNERSHIP  
NAMES, ADDRESSES, AREAS, ETC.

GRID STATE PLANE COORDINATES  
THIS IS A STATE PLANE COORDINATE PROJECT.  
ALL DIMENSIONS, DISTANCES AND AREAS ON THIS  
PROJECT ARE GRID, EXCEPT FOR THE EXISTING  
R/W WIDTH, WHICH IS RECORD. THE COMBINATION  
SCALE FACTOR IS 0.99922311

A CONTROLLED ACCESS FACILITY

ASSOCIATED PROJECT ID.
IM 90-3(76)173 PE

RELATED PROJECTS
I-IG 90-3(21)172
I-IG 90-3(39)176

FHWAMDT APPROVAL	10/1/01
MAP REVISED	

NOTES: 1. ALL MEASUREMENTS ARE METRIC EXCEPT AS NOTED



RIGHT-OF-WAY BASELINE COORDINATE TABLE			
POINT NO.	NORTHING	EASTING	DESCRIPTION
1000	254, 656. 6494	352, 034. 4398	POT 96+99. 87
1001	253, 928. 6702	352, 501. 7272	TS 105+64. 93
1002	253, 877. 3622	352, 534. 6617	PIS 106+25. 89
1003	253, 850. 8785	352, 549. 7656	SC 106+56. 37
1004	253, 418. 2647	351, 791. 2049	CC CURVE EB-1
1005	253, 675. 6897	352, 649. 6772	PIC 108+58. 04
1006	253, 474. 4308	352, 662. 6487	CS 110+52. 77
1007	253, 444. 0059	352, 664. 6097	PIS 110+83. 25
1008	253, 383. 0416	352, 665. 3417	ST 111+44. 21
1009	252. 857. 7206	352. 671. 6494	POT 116+69. 56

GPS CONTROL ABSTRACT (* SEE NOTE)				
POINT NUMBER	NORTHING	EASTING	COMBINATION SCALE FACTOR	LOCATION DESCRIPTION
179A	254143.989	352578.344	0.99921812	NORTH OF CL MEDIAN AND OVERPASS ON A RIDGE MARK IS 1M NORTH OF TRAIL AND 10M EAST OF EASTERLY RIGHT-OF-WAY FENCE
179B	253919.814	352757.445	0.99922245	315M EASTERLY OF CL MEDIAN AND OVERPASS ALONG ROAD, SOUTH 233M ALONG FENCE. MARK IS 1M EAST OF THE FENCE
601	253461.813	352640.353	0.99922523	PK NAIL IN PAVEMENT ON THE EAST SHOULDER OF THE FRONTAGE ROAD, 0.2M WEST OF FOG LINE 180M NORTH OF MPI80
602	253642.660	352942.454	0.99922436	315M EASTERLY OF CL MEDIAN AND OVERPASS ALONG ROAD, SOUTH 510M ALONG FENCE TO A GATE, THROUGH GATE AND 150M ALONG A ROAD. MARK IS 50M SOUTH OF ROAD AND 20M NORTH FROM SMALL DRAINAGE
603	253737.009	352757.753	0.99922430	315M EASTERLY OF CL MEDIAN AND OVERPASS ALONG ROAD, SOUTH 424M ALONG FENCE. MARK IS 2M EAST OF FENCE
604	254050.575	352405.448	0.99922488	MARK IS NORTH OF OVERPASS, 15M WEST OF THE SOUTH BOUND LANE, AND NEAR THE EASTERLY TOE OF SLOPE OF THE SOUTH BOUND EXIT
605	254325.503	352749.861	0.99921676	500M EASTERLY AND NORTHERLY OF CL MEDIAN AND OVERPASS ALONG ROAD. MARK IS 30 M WEST OF ROAD, 100M SOUTHWESTERLY OF MAILBOXES AND 5M SOUTH OF A TRAIL
A448	258615.775	345246.887	0.99922291	USC&GS BM NORTHWEST OF GARRISON. SEE NGS DESCRIPTION
D508	250122.683	352544.813	0.99922940	USC&GS BM NORTHWEST OF DEER LODGE. SEE NGS DESCRIPTION
GINA	244274.253	303044.728	0.99918988	B ORDER GPS MARK NORTHWEST OF PHILIPSBURG. SEE NGS DESCRIPTION
HELENA GPS	262665.327	409186.224	0.99922880	B ORDER GPS MARK AT HELENA. SEE NGS DESCRIPTION
K448	255646.303	350775.870	0.99922439	USC&GS BM SOUTH OF GARRISON. SEE NGS DESCRIPTION
L448	254600.409	352090.885	0.99922444	USC&GS BM SOUTH OF GARRISON. SEE NGS DESCRIPTION
M448	253223.582	352647.491	0.99922590	USC&GS BM NORTH OF DEER LODGE. SEE NGS DESCRIPTION
MISSOULA GPS	307413.681	250809.174	0.99924344	B ORDER GPS MARK AT MISSOULA AIRPORT. SEE NGS DESCRIPTION
N448	251636.957	352611.462	0.99922765	USC&GS BM NORTH OF DEER LODGE. SEE NGS DESCRIPTION
NEVADA	302676.766	329906.963	0.99918900	B ORDER GPS MARK NORTHWEST OF HELMVILLE. SEE NGS DESCRIPTION
P447	279363.285	301895.350	0.99923110	USC&GS BM WEST OF DRUMMOND. SEE NGS DESCRIPTION
WARM SPRINGS S BASE	220270.524	346374.650	0.99926828	B ORDER GPS MARK NEAR WARM SPRINGS. SEE NGS DESCRIPTION

[illegible]

\* NOTE:

FOR O'NEILL CREEK PIPE REPLACEMENT ONLY. CONTROL WAS DERIVED USING THE GPS COORDINATES FROM IR 90-3(70)179 (DEER LODGE VALLEY REST AREA) CONTROL NUMBER 2003. ADJUSTED BEARINGS ARE APPLICABLE ONLY TO THIS PORTION OF THE WORK.

BEARING EQUATION - S 35° 13' 00" E AS-BUILT (MAINLINE -EASTBOUND) =  
S 32° 41' 47" E THIS SURVEY (MAINLINE - EASTBOUND) (-2° 31' 13")

THE COMBINATION SCALE FACTOR FOR THIS PORTION OF THE PROJECT IS 0.99922311.

## GRID STATE PLANE COORDINATES

THIS IS A STATE PLANE COORDINATE PROJECT.  
ALL DIMENSIONS, DISTANCES AND AREAS ON THIS  
PROJECT ARE GRID, EXCEPT FOR THE EXISTING  
R/W WIDTH, WHICH IS RECORD. THE COMBINATION  
SCALE FACTOR IS 0.99922311

NOTES: 1. ALL MEASUREMENTS ARE METRIC EXCEPT AS NOTED

2. THE PROPOSED R/W LINE WHERE A SPIRAL CURVE TRANSITION IS USED IS A CHORD RATHER THAN A CONCENTRIC CURVE.

3. THE ENGLISH AREAS ARE FOR INFORMATIONAL

BACKSLOPE LIMITS INCLUDE ROUNDING  
CONSTRUCTION LIMITS:

TOP OF CUT SECTION  
DITCH BOTTOM  
TOE OF FILL

FHWA/DOT APPROVAL _____ SPECIAL AGENT IN CHARGE	10/1/00
---	---------

STATE	RIGHT OF WAY ID.	SHEET	TOTAL
		NO.	SHEET
MONTANA	IM 90-3(76)173	2	3

PROJECT NUMBER 3097-076

GARRISON - BECK HILL  
(O'NEILL CREEK CROSSING)

RIGHT-OF-WAY COORDINATE ASCII FILES

R/W BREAK COORDINATES: A097RWBK.XYZ

R/W BASELINE COORDINATES: A097RWBL.XYZ

ALL FILES ARE LOCATED ON THE CADD SERVER  
IN THE RO DIRECTORY, UNDER PROJECT: A097



