

FAP 217C

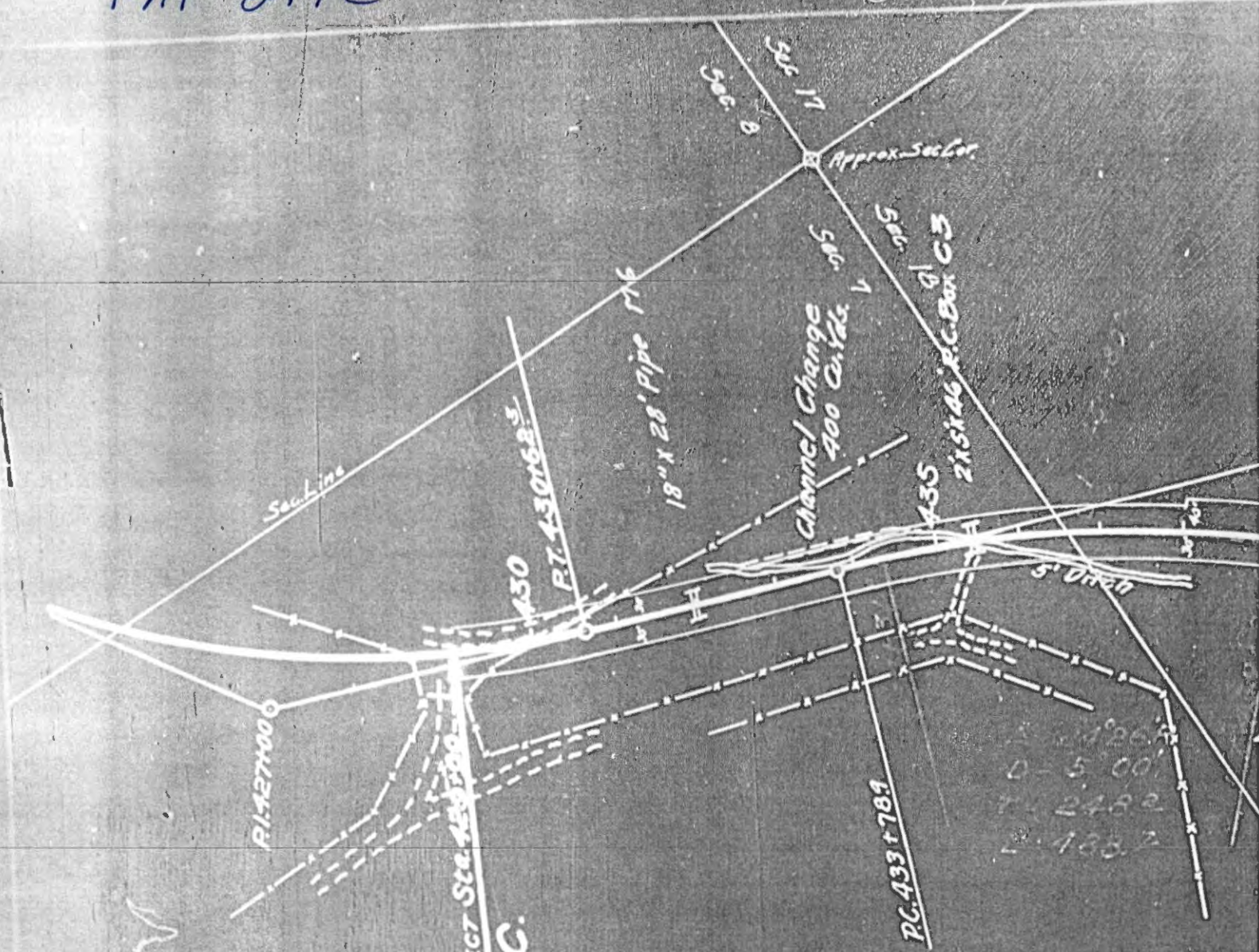

BEGINNING OF PROJECT Sta. 430+00
F.A.P. 217C.

2-11-26
0-5.00'
1-2482
2-130.2

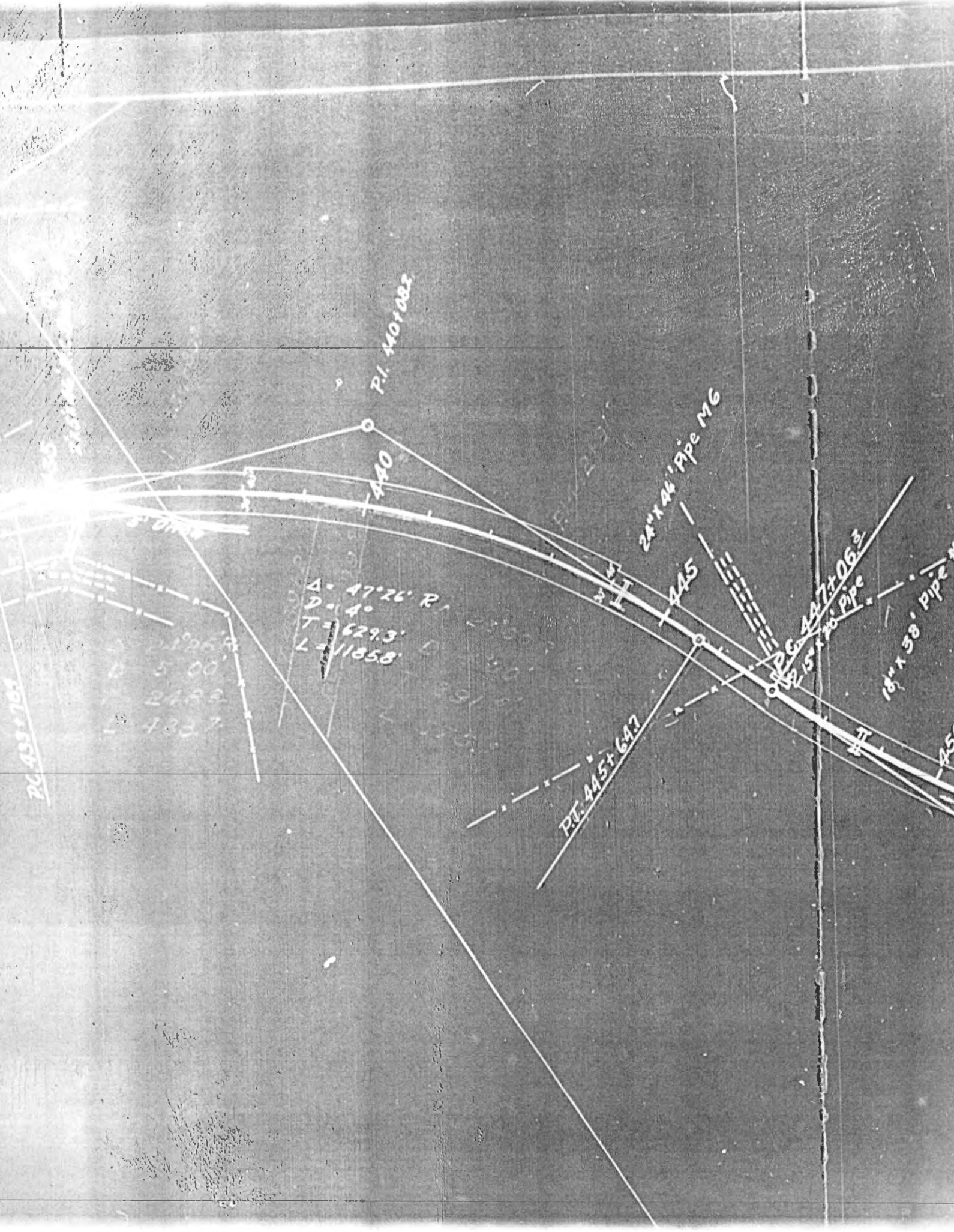

P.I. 440+08.3

440

24" x 46" Pipe MG

445

447+06.3

18" x 39" Pipe MG

PT. 445+6.47

$\Delta = 47^{\circ}26' R$
 $D = 4'$
 $T = 629.3'$
 $L = 1185.8'$

26-439+70.1

2196.9
4-5-00
248.2
4-133.7

450

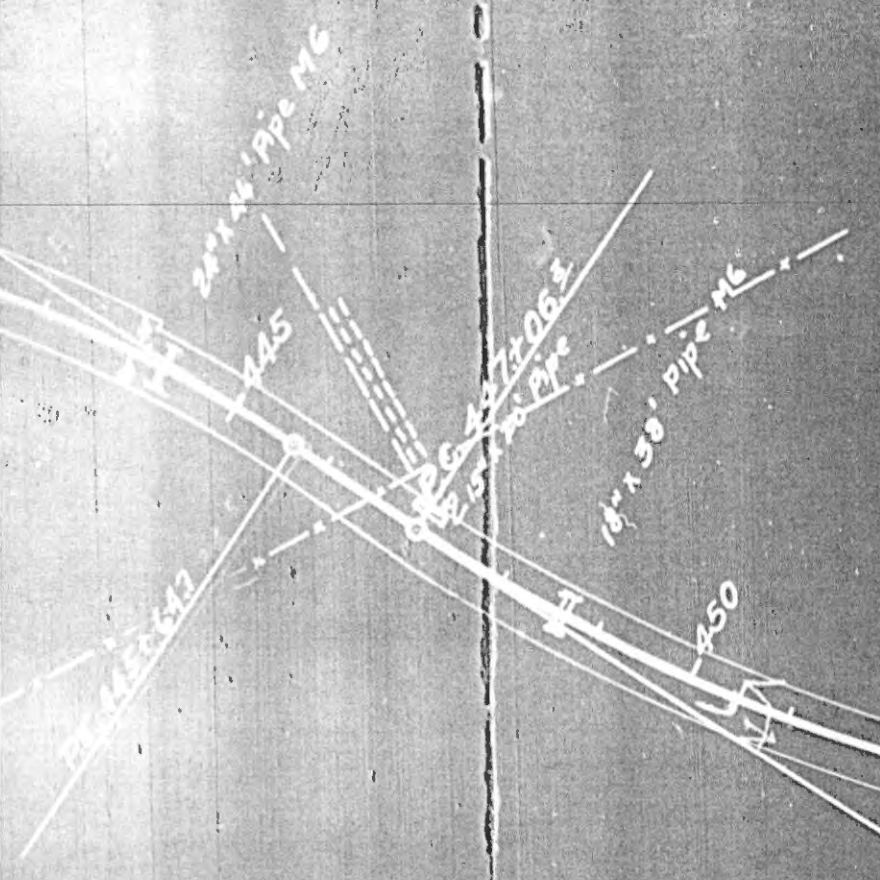

$\Delta = 35^{\circ} 25' L$
 $D = 3^{\circ} 00'$
 $T = 609.9'$
 $L = 1180.9'$

P.I. 453+62

EQUA. P.T. 458+86.9 Back =
100 Ahead

$\Delta = 35^{\circ} 25' L$
 $D = 3^{\circ} 00'$
 $T = 609.9'$
 $L = 1180.9'$

18" x 33" Pipe M6

18" x 28" Pipe M6

P.I. 453+62.0

EQUA.
P.T. 458+86.9 Back =
0+00 Ahead.

1/4 Line

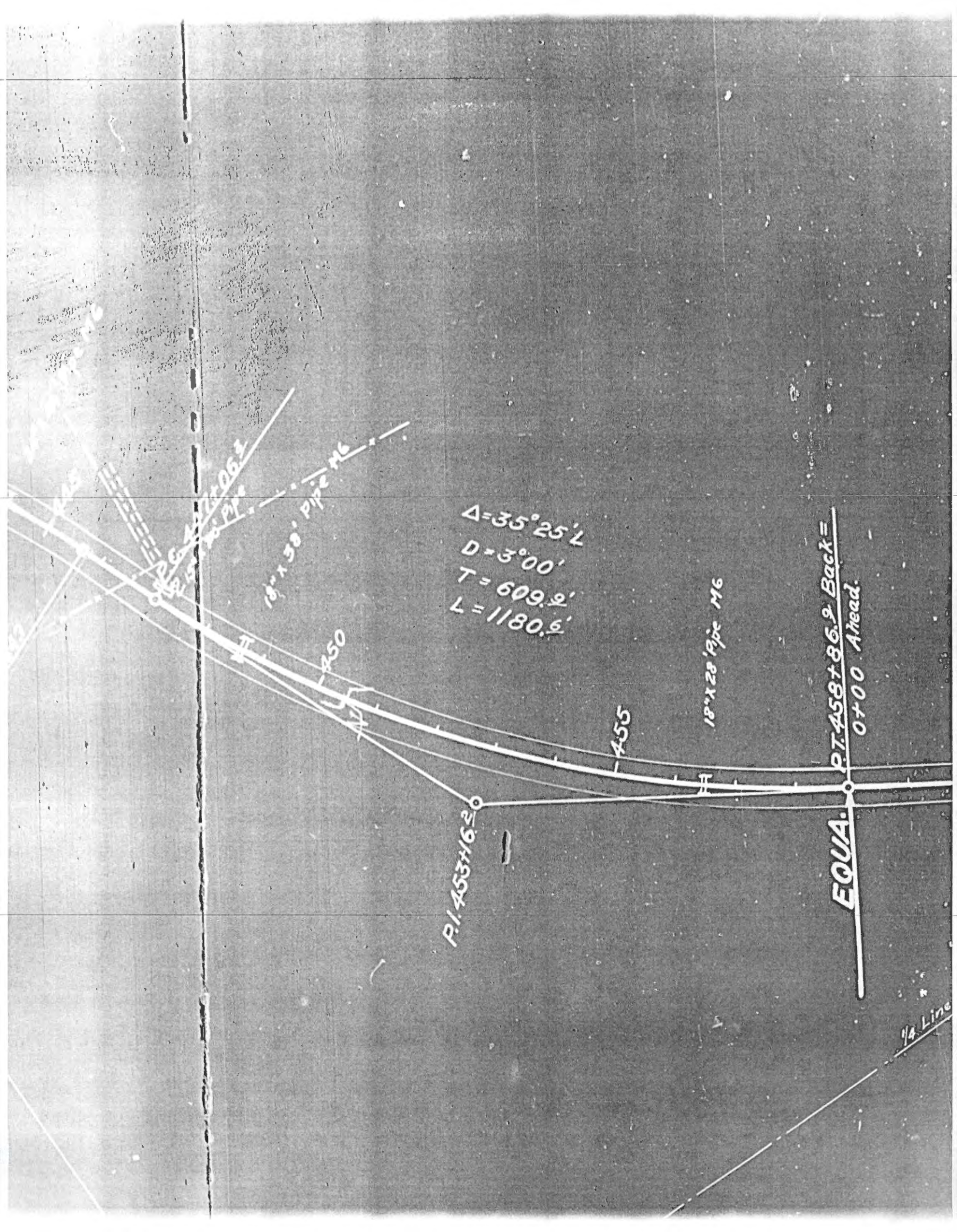

EQUA. PT 4587.86. P. Back =
0+00 Ahead.

1/2 Line

Creek
5
30" x 30' Pipe M6

18" x 28' Pipe M6

18" x 28' Pipe M6
ditch

18" x 28' Pipe M6
ditch

30" x 28' Pipe Supply - M8a

S. 31° 36' W.
10

Creek

Uncl. Excav 421 Cu Yd

18x28 Pipe M6
ditch
30x28 Pipe M6
ditch

18x28 Pipe Siphon M8a

Hay
bin

18x28 Pipe M6

20 MEADOW

ditch
28x28 Pipe M6
ditch

Channel Change
25 W. Yds.
ditch

Hay
bin

25

Culti

HAY

-plow

-Irr.

-Irr.

-plow

PEA

-plow
-plow

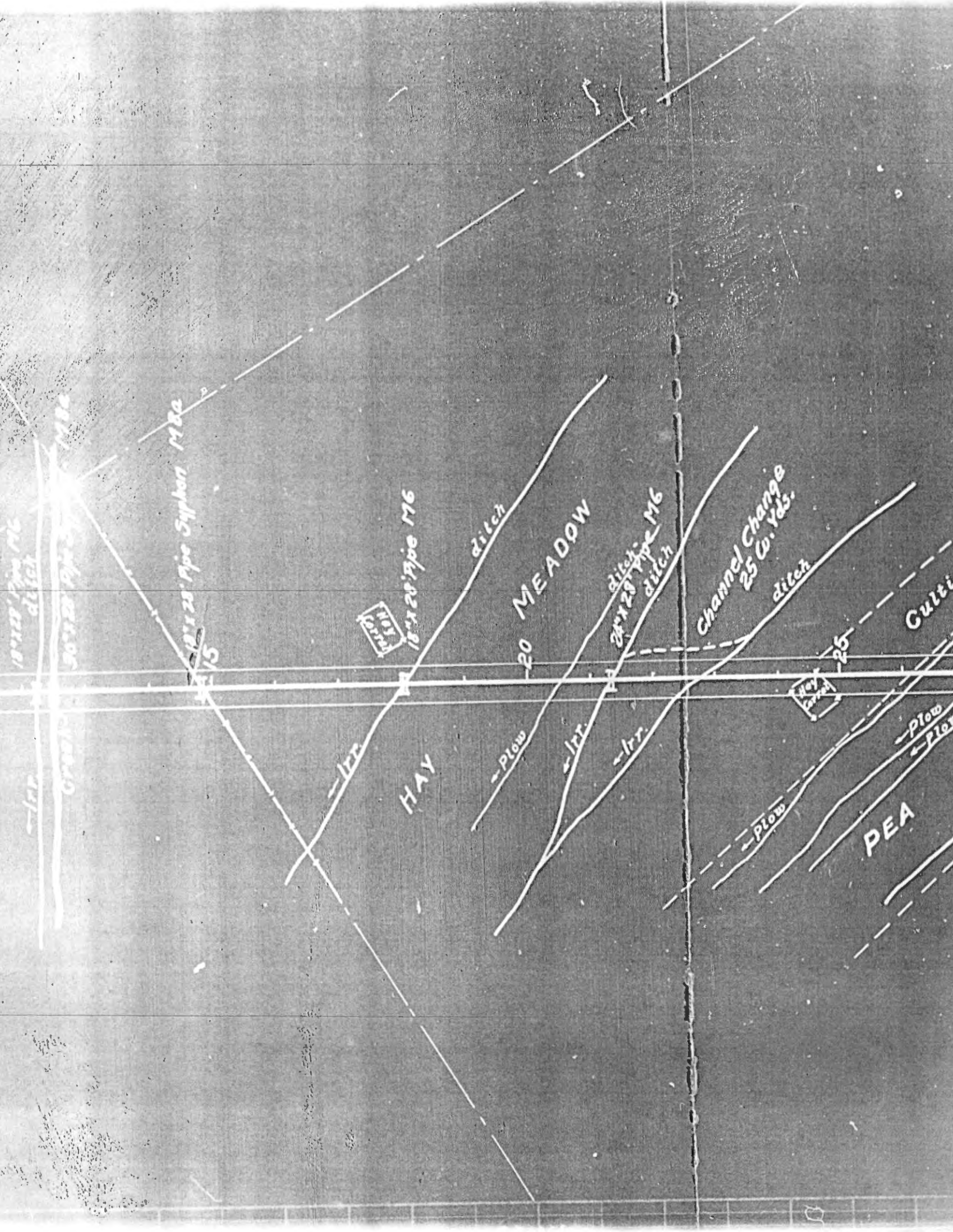

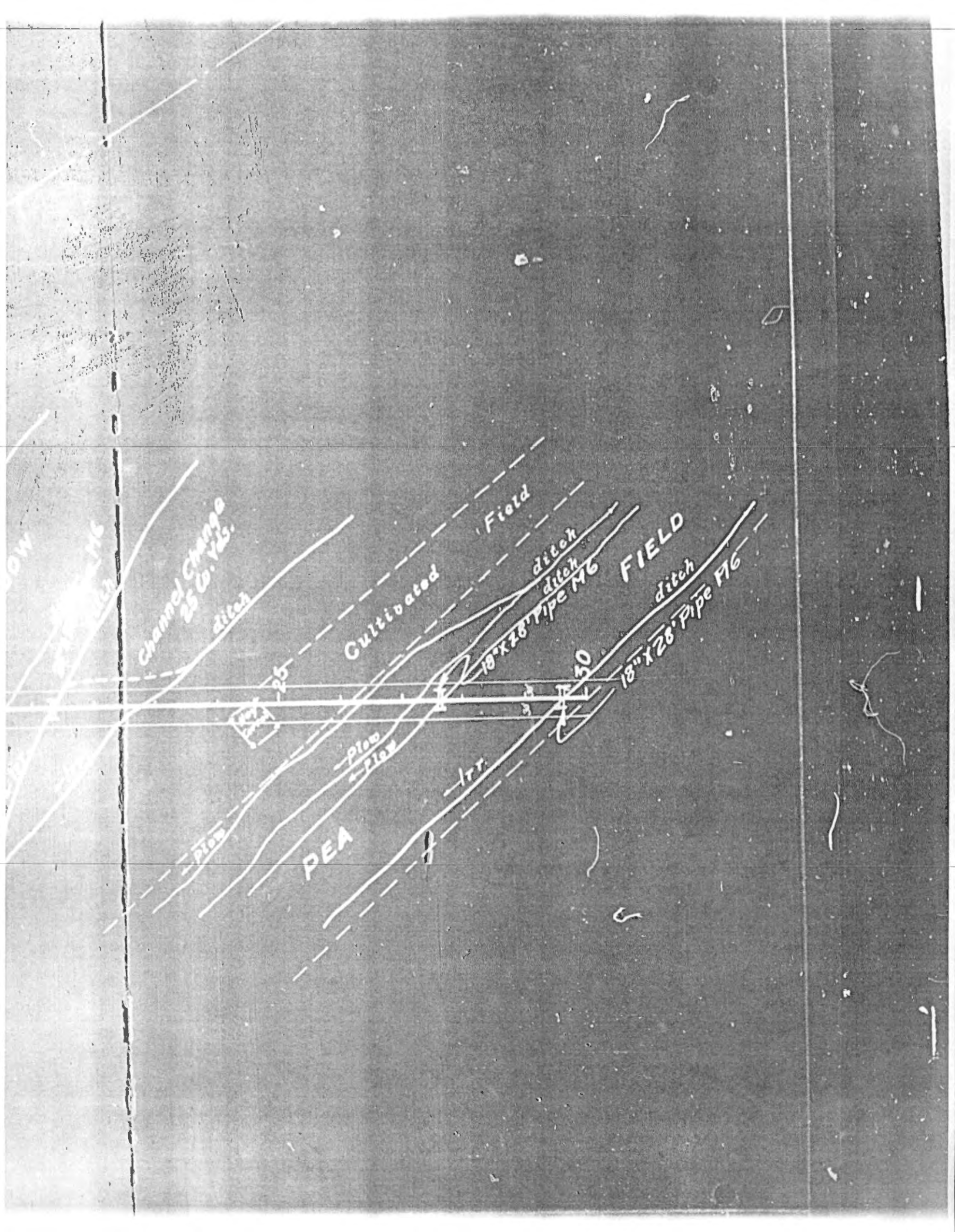

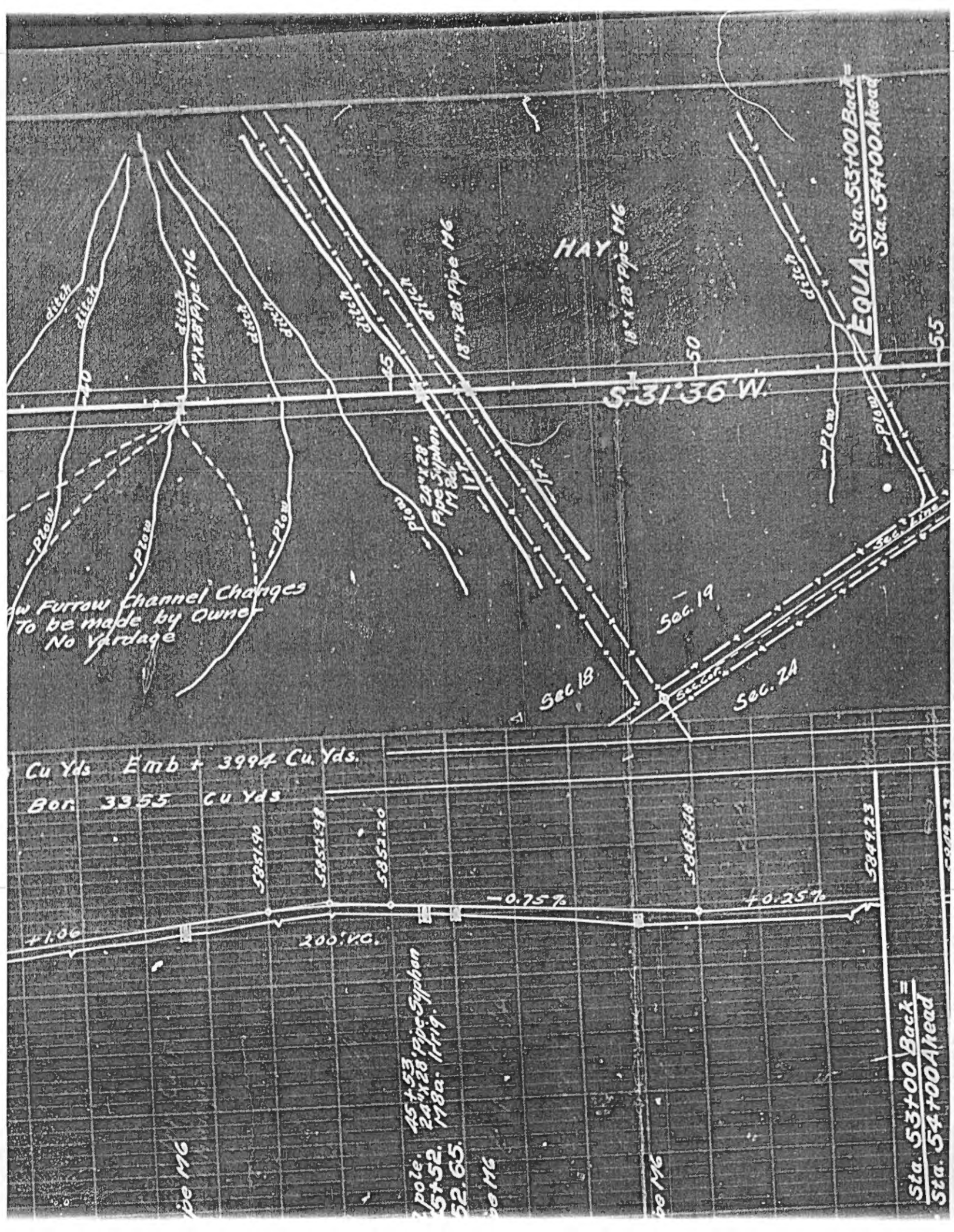

New Furrow Channel Changes
To be made by Owner
No Yardage

Cu Yds Emb + 3994 Cu Yds.
Bor 3355 Cu Yds



2 pole.
15+52.
52.65.
20 MG

Sta. 53+00 Back =
Sta. 54+00 Ahead

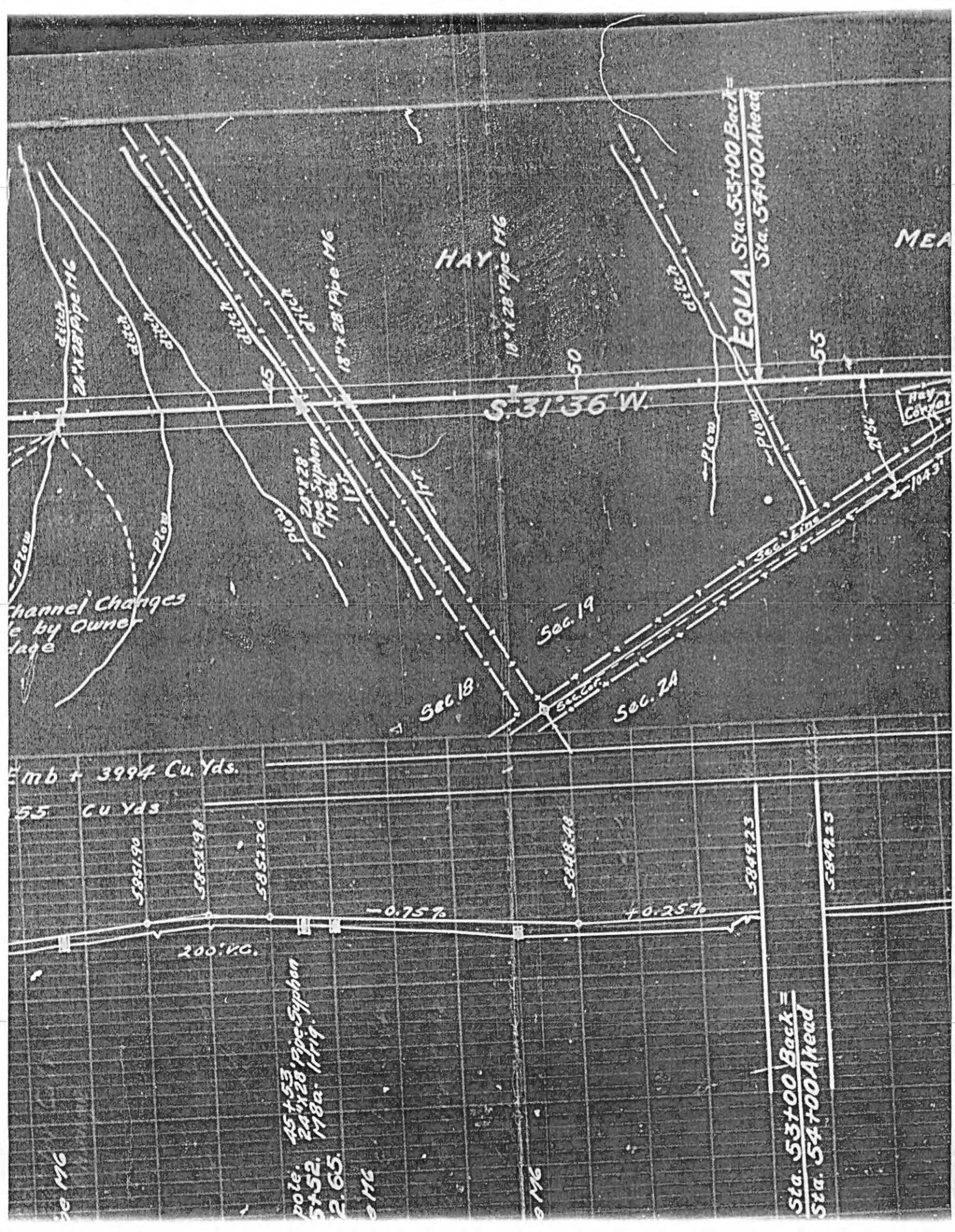

MEAN

HAY

S. 31° 36' W

EQUA. Sta. 53+00 Back =
Sta. 54+00 Ahead

24" x 28" Pipe M6

18" x 28" Pipe M6

18" x 28" Pipe M6

24" x 28" Pipe Siphon
148a
148b

Sec. 18

Sec. 19

Sec. 21

Channel Changes
by Owner

Emb + 3994 Cu. Yds.

55 CU YDS

200' V.C.

-0.75%

+0.25%

pole. 45 + 53
24" x 28" Pipe Siphon
5 + 52
148a. 148b.
2.65.
0 MG

Sta. 53+00 Back =
Sta. 54+00 Ahead

5851.70

5851.98

5852.20

5848.48

5849.23

5849.23

0 MG

0 MG

Hay
Cover

104.3'

55

27.56'

104.3'

Plow

Plow

Plow

ditch

ditch

ditch

ditch

Plow

Plow

ditch

ditch

ditch

ditch

ditch

ditch

ditch

ditch

ditch

ditch

ditch

ditch

ditch

ditch

ditch

ditch

ditch

ditch

ditch

ditch

ditch

HAY
18" x 28' Pipe MG

50

S. 31° 36' W

ditch

Plow

EQUA. Sta. 53+00 Back =
Sta. 54+00 Ahead

55

MEADOW

18" x 28' Pipe MG

Key
Coral

27' 50"

1043' 70

5712.2

FIELD

18" x 28' Pipe MG H-60

T. 55 R. 9 E.
T. 55 R. 8 E.
GR.

Sec. 19

Sec. 2A

Sec. 18

5848.40

+0.25%

5849.23

5849.23

+0.25%

5850.98

Sta. 53+00 Back =
Sta. 54+00 Ahead

the MG Irrig.

ice post
59+87
52.05

the MG

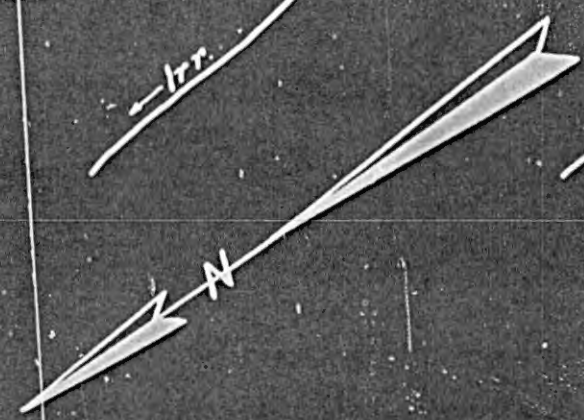
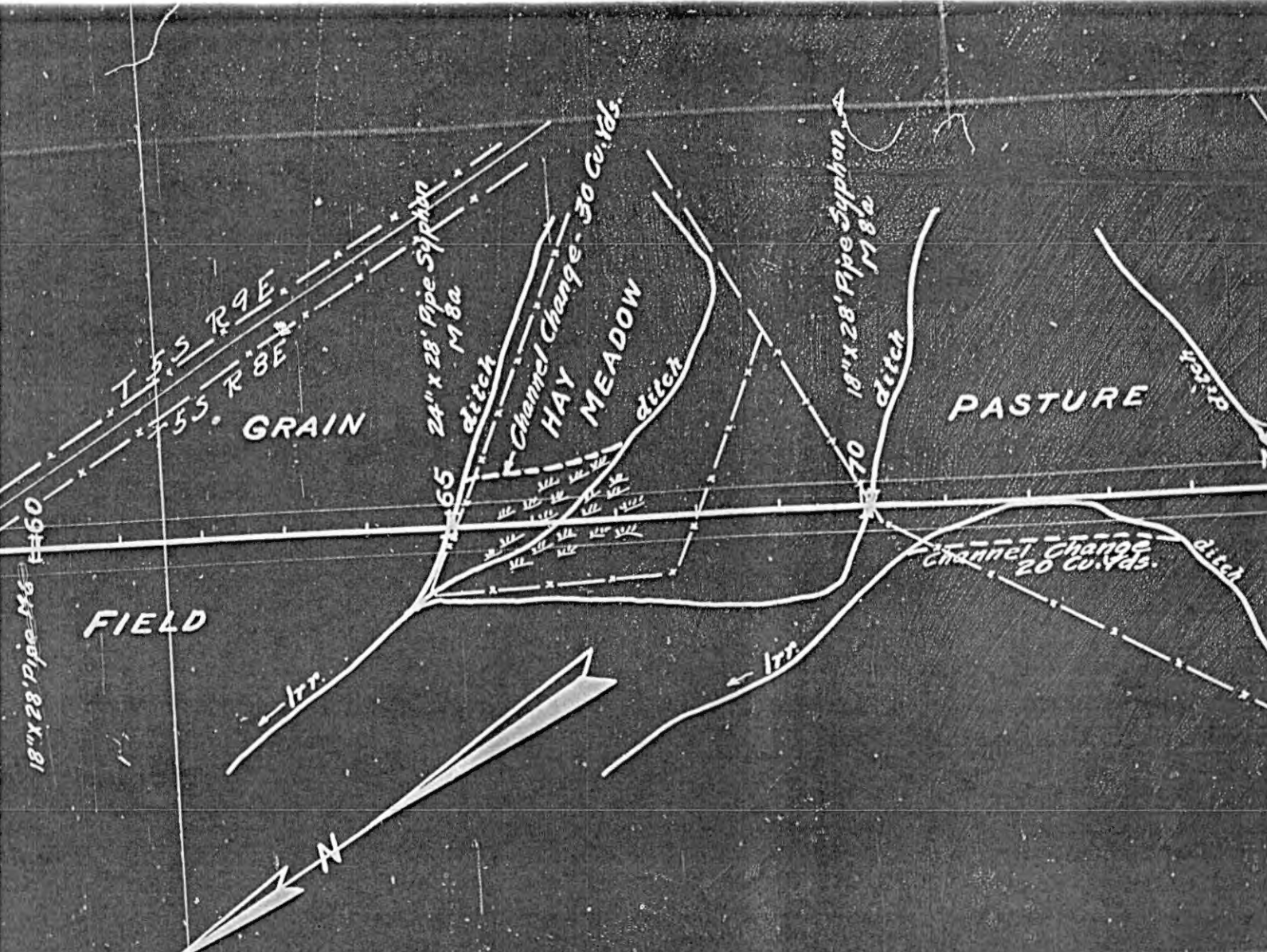

Excav. Uncl. 598 Cu. Yds. Emb
 Bor 2963 Cu Yd

+0.70%

force post
 9+87
 2.05
 M6

force post
 70+60
 55.68
 M8a

force post
 70+22
 18" x 28' Pipe Syphon
 M8a
 70+60
 55.68

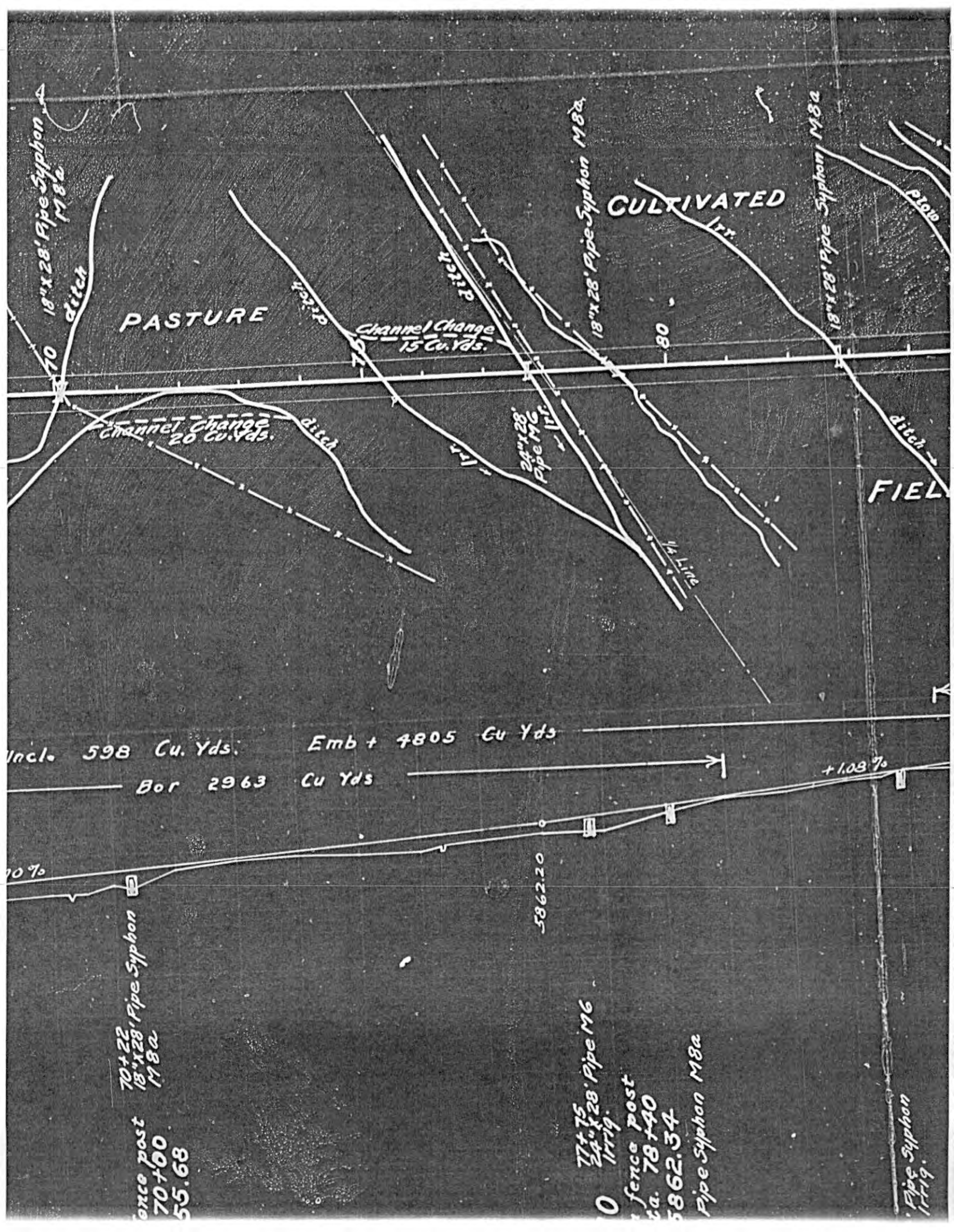

18" x 28' Pipe Syphon M8a
70
ditch

PASTURE

Channel Change
15 Cu. Yds.

CULTIVATED
177

18" x 28' Pipe Syphon M8a

18" x 28' Pipe Syphon M8a

FIELD

Channel Change
20 Cu. Yds.

24" x 28' Pipe M6

80

W. Line

Incl. 598 Cu. Yds.

Emb + 4805 Cu Yds

Bor 2963 Cu Yds

+1.08%

10%

5862.20

70+22
18" x 28' Pipe Syphon
M8a

fence post
70+00
55.68

77+75
24" x 28' Pipe M6
1779

fence post
78+40
5862.34

Pipe Syphon M8a

Pipe Syphon
1779

FED. ROAD DIST. No.	STATE	FED. AID PROJ. NO.	FISCAL YEAR	SHEET NO.	TOTAL SHEETS
	MONT.	217-C		4	30

18"x28" Pipe Syphon M8a

CULTIVATED
Irr.

18"x28" Pipe Syphon M8a

Pipe Row Irr

18"x28" Pipe Syphon M8a

Channel Change
15 Cu. Yds.

L-90

80

85

FIELD

ditch

ditch

ditch

ditch

1/2 Line

Bor. 1244 Cu Yds.

+0.40%

+1.09%

5872.98

587

24"x28" Pipe M6
14719.

ence post
78+40
52.34

e Syphon M8a

e Syphon

ence post 88+61
18"x28" Pipe Syphon
M8a
88+15
872.66

58

B.M. 38

Nail in fence
63' L. Sta. 597
Elev. 5852.0
60 +00
18" x 28' Pipe M
Drain

65 x 16
24" x 28' Pipe
M8a

39
B.M. 39
Spike in fence
Sta. 7
53' L.
Elev. 5851

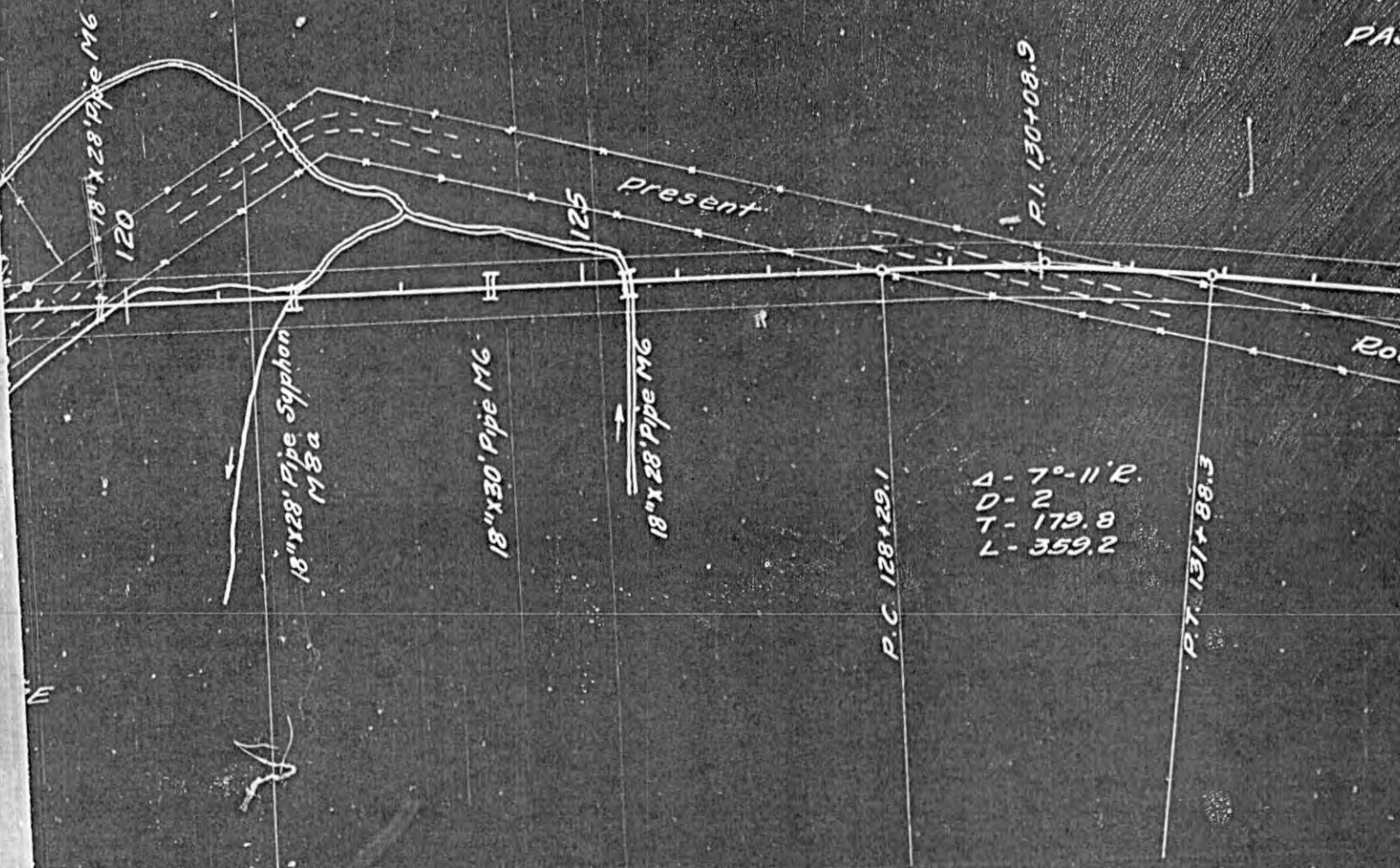

Excav. Uncl. 3644 Cu Yds
O.H. 3900 Sto Yds

