

PLANS

NOT

TO

SCALE

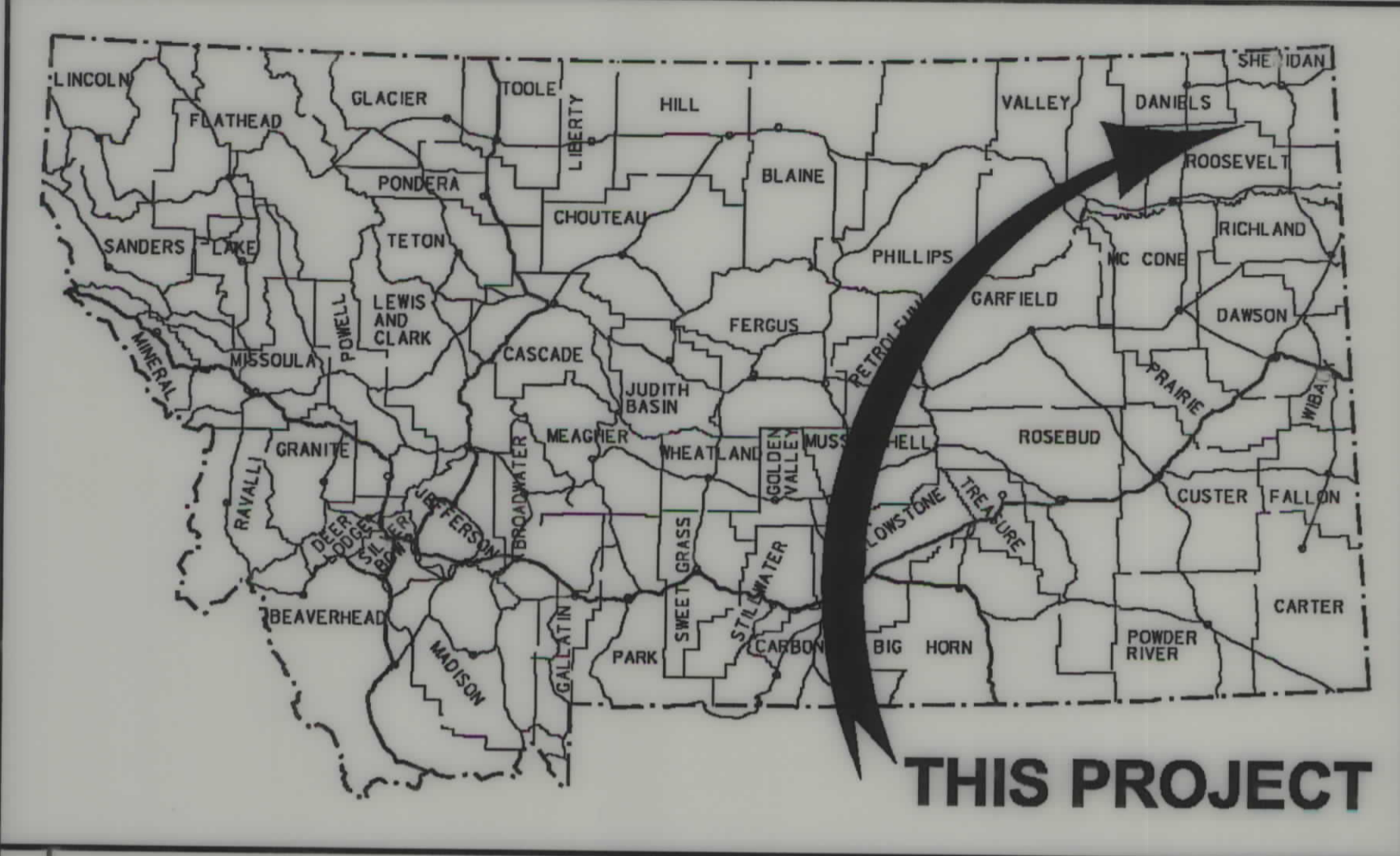

MONTANA DEPARTMENT OF TRANSPORTATION

STATE	RIGHT OF WAY ID.	SHEET NO.	TOTAL SHEETS
MONTANA	BR 251-1(3)18	1	2
PROJECT NUMBER		4880-003	
KIRN COULEE-37 KM NE POPLAR			

RIGHT OF WAY PLAN OF FEDERAL AID PROJECT BR 251-1(3)18 KIRN COULEE-37 KM NE POPLAR ROOSEVELT COUNTY

0.2 Kilometers

CONVENTIONAL SIGNS

- PROPOSED RIGHT OF WAY LINE
- EXISTING RIGHT OF WAY LINE
- RAILROAD RIGHT OF WAY LINE
- RIGHT OF WAY BASELINE
- STK'D CENTERLINE
- SECTION LINE
- OWNERSHIP BOUNDARY
- FULL ACCESS CONTROL
- LIMITED ACCESS CONTROL
- EXISTING ACCESS CONTROL
- PRESENT TRAVELED WAY (P.T.W.)
- FENCE LINE
- EXISTING GUARDRAIL
- PROPOSED GUARDRAIL
- GATE IN FENCE
- CATTLE GUARD: EXIST. - PROPOSED
- SECTION CORNER
- 1/4 SECTION CORNER
- CLOSING CORNER
- MEANDER CORNER
- CENTER OF SECTION
- RIGHT OF WAY MONUMENT
- PROPERTY CORNER PIN
- POWER POLE IN PLACE
- TELEPHONE POLE IN PLACE
- TELEGRAPH POLE IN PLACE
- LIGHT POLE
- PROPOSED CULVERT
- EXISTING CULVERT
- OUTLET DITCH
- INLET DITCH
- EXISTING DITCH
- CHANNEL CHANGES
- DITCH BLOCK
- RIPRAP
- BRIDGES
- RAILROADS
- PARCEL NUMBERS
- APPROACH: EXIST.- PROPOSED

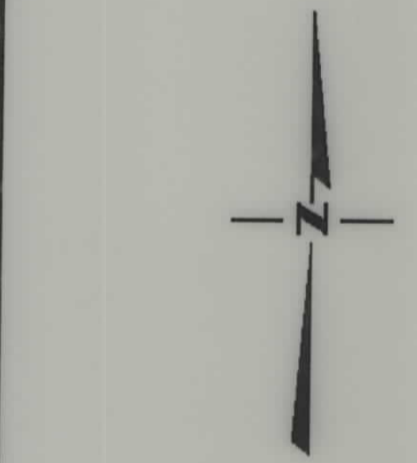

ASSOCIATED PROJECT ID.
BR 251-1(3)18 PE
BR 251-1(4)18 CONST

RELATED PROJECTS
S-15(3)

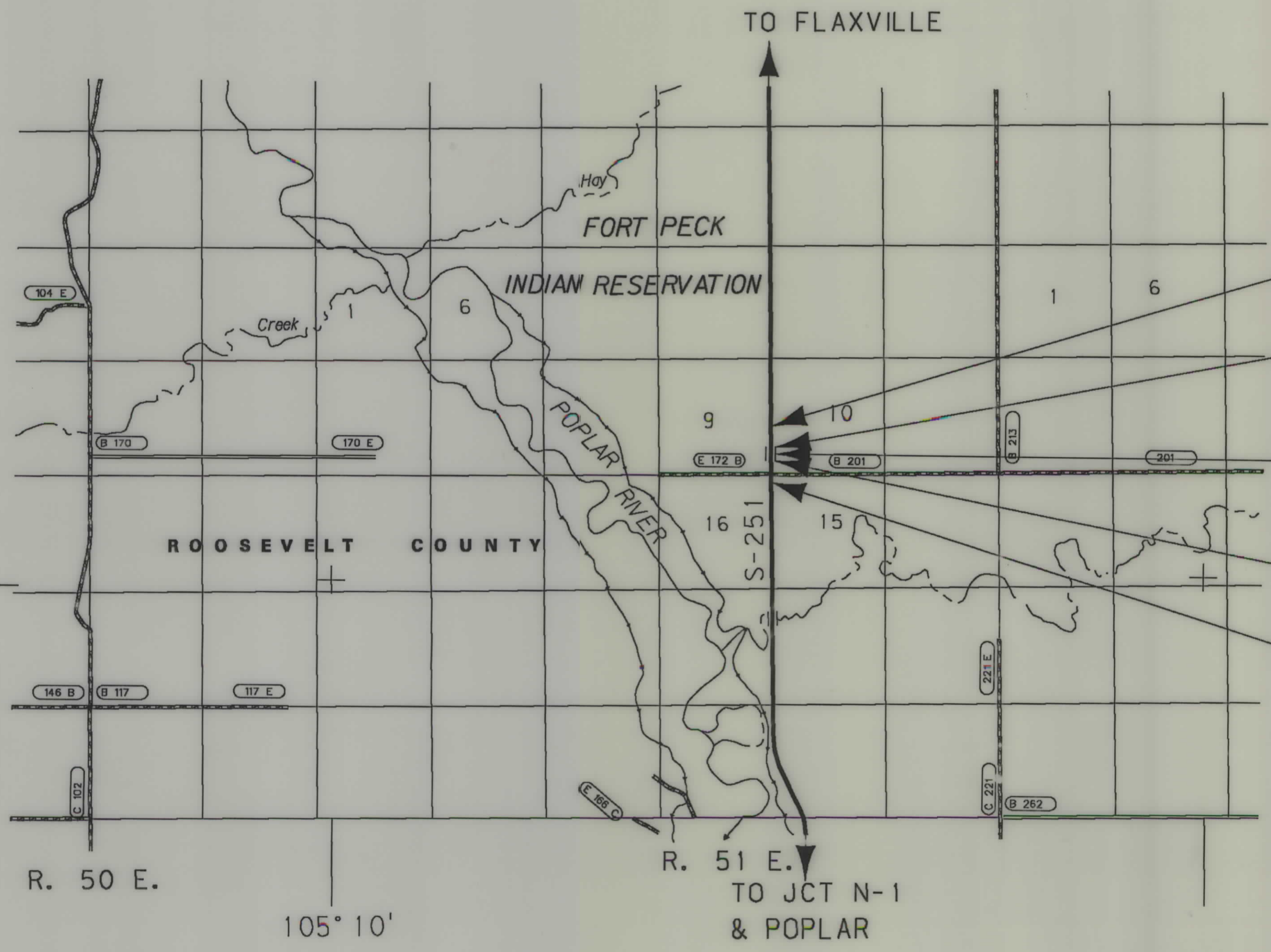

STA. 12+65.00 (MET)
END CONNECTION

STA. 12+50.00 (MET) END BR 251-1(3)18 =
STA. 943+71.92 ON FAS S-15(3)

STA. 11+29.08
7.3 m x 7.6 m TIMBER BR. IN PL.

STA. 10+50.00 (MET) BEGIN BR 251-1(3)18 =
STA. 936+45.55 ON FAS S-15(3)

STA. 10+35.00 (MET)
BEGIN CONNECTION

GRID STATE PLANE COORDINATES

THIS IS A STATE PLANE COORDINATE PROJECT. ALL DIMENSIONS, DISTANCES AND AREAS ON THIS PROJECT ARE GRID, EXCEPT FOR THE EXISTING R/W WIDTH DIMENSION, WHICH IS RECORD. THE COMBINATION SCALE FACTOR IS 0.99356957

NOTES: 1. ALL MEASUREMENTS ARE METRIC EXCEPT AS NOTED

RDROW

MONTANA
CADD

3
2

REBMUMI GIMWARG

REBMUMI GIMWARG

REBMUMI GIMWARG

BR 251-1(3)18 SH 1 OF 2

