

THIS PROJECT

MONTANA DEPARTMENT OF TRANSPORTATION

RIGHT OF WAY PLAN FEDERAL AID PROJECT STPS 569-1(7)19 JCT. MT 43-NORTH DEER LODGE COUNTY

LENGTH 0.50 MILES

| STATE | RIGHT OF WAY | SHEET NO. | TOTAL SHEETS |
|---------------------|--------------|-----------------|--------------|
| MONTANA | | 1 | 2 |
| R/W ID. | | STPS 569-1(7)19 | |
| UNIFORM PROJECT NO. | | 4909-007-000 | |

JCT. MT 43-NORTH

RIGHT-OF-WAY COORDINATE ASCII FILES

R/W BREAK COORDS: 4909R0BRK001.TXT
R/W BASELINE COORDS: 4909R0BAS001.TXT
ALL FILES ARE LOCATED ON THE CADD SERVER
IN THE RO DIRECTORY, UNDER PROJECT: 4909

SEE SHEET NO. 2 FOR OWNERSHIP
NAMES, ADDRESSES, AREAS, ETC.

PLAN LEGEND

| | |
|---------------------------------|------------------|
| PROPOSED RIGHT OF WAY LINE | --- |
| EXISTING RIGHT OF WAY LINE | --- |
| RAILROAD RIGHT OF WAY LINE | --- |
| RIGHT OF WAY BASELINE | --- |
| STK'D CENTERLINE | --- |
| SECTION LINE | --- |
| OWNERSHIP BOUNDARY | --- |
| FULL ACCESS CONTROL | AG AG |
| LIMITED ACCESS CONTROL | /// /// |
| EXISTING ACCESS CONTROL | /// /// |
| PRESENT TRAVELED WAY (P.T.W.) | --- |
| FENCE LINE | x x x x |
| EXISTING GUARDRAIL | - - - |
| PROPOSED GUARDRAIL | - - - |
| GATE IN FENCE | - - |
| CATTLE GUARD: EXIST. - PROPOSED | --- -- |
| SECTION CORNER | FOUND UNFOUND |
| 1/4 SECTION CORNER | FOUND UNFOUND |
| CLOSING CORNER | FOUND UNFOUND |
| MEANDER CORNER | FOUND UNFOUND |
| CENTER OF SECTION | FOUND UNFOUND |
| 1/16 SECTION CORNER FOUND | FOUND UNFOUND |
| RIGHT OF WAY MONUMENT | FOUND CALCULATED |
| PROPERTY CORNER PIN | FOUND CALCULATED |
| POWER POLE IN PLACE | FOUND CALCULATED |
| TELEPHONE POLE IN PLACE | FOUND CALCULATED |
| TELEGRAPH POLE IN PLACE | FOUND CALCULATED |
| LIGHT POLE | FOUND CALCULATED |
| PROPOSED CULVERT | --- |
| EXISTING CULVERT | --- |
| OUTLET DITCH | --- |
| INLET DITCH | --- |
| EXISTING DITCH | --- |
| CHANNEL CHANGES | CH. CH. |
| DITCH BLOCK | --- |
| RIPRAP | --- |
| BRIDGES | --- |
| RAILROADS | --- |
| PARCEL NUMBERS | --- |
| APPROACH: EXIST.- PROPOSED | --- |



| ASSOCIATED PROJECTS |
|---------------------|
| STPS 569-1(1)15 PE |

| RELATED PROJECTS |
|------------------|
| FAS 352D |

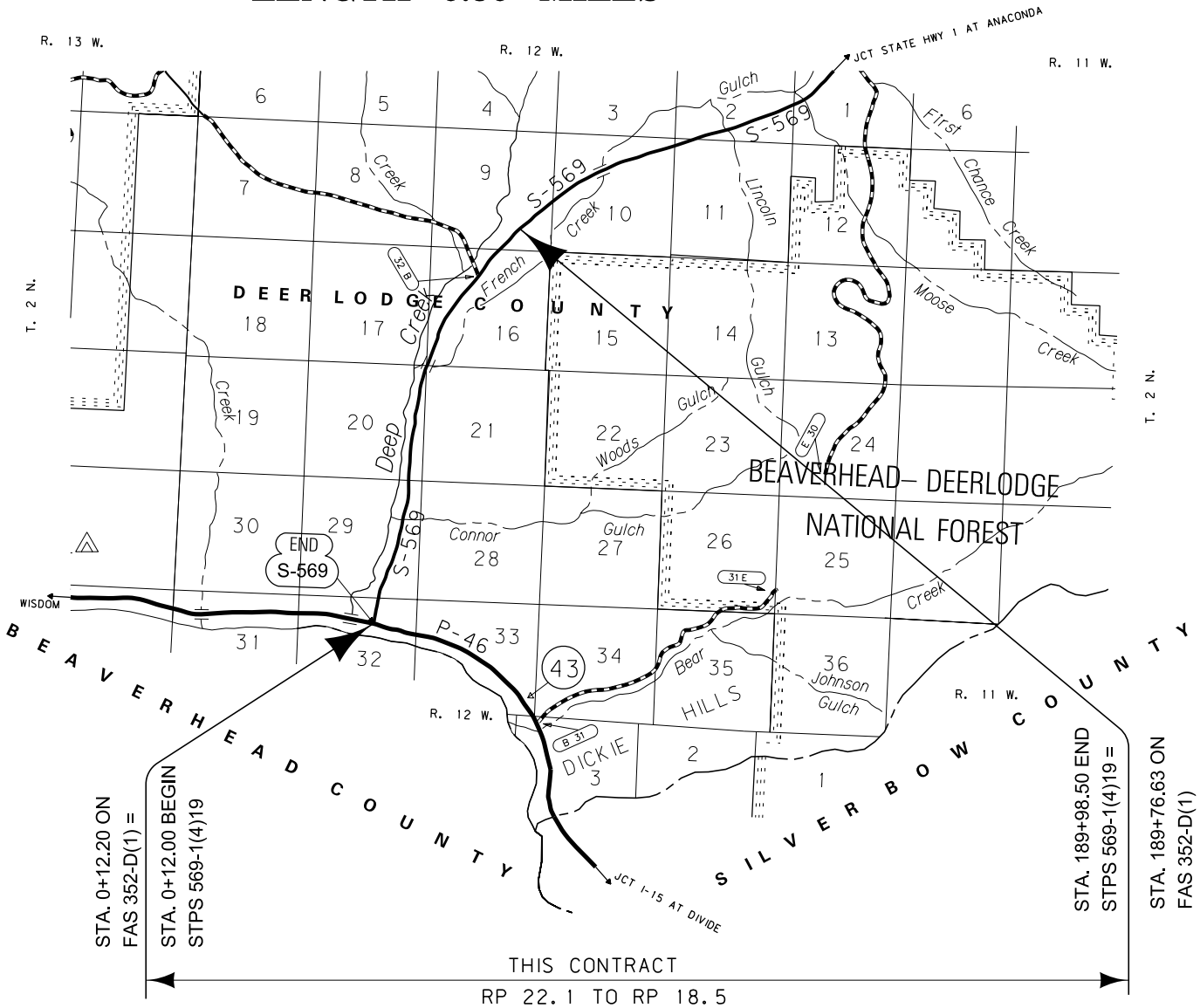

FOR EXISTING R/W RETRACEMENT, SEE
C. O. S. 364-C & 366-C

GRID STATE PLANE COORDINATES

THIS IS A STATE PLANE COORDINATE PROJECT. ALL
DIMENSIONS, DISTANCES AND AREAS ON THIS PROJECT
ARE GRID, EXCEPT FOR THE EXISTING R/W WIDTH
DIMENSION, WHICH IS RECORD.
THE COMBINATION SCALE FACTOR IS 0.99930224

| | |
|--------------------------------------|----------------------|
| CONSTRUCTION LIMITS | MAP REVISED 10/16/12 |
| CUT SECTION | --- |
| TRANSITION | --- |
| TOE OF FILL | --- |
| BACKSLOPE LIMITS INCLUDE ROUNDING | --- |
| FHWA/MDT APPROVAL | 9/11/2012 |

| | | |
|---|---|-------------------------|
| 3 | MDTA MONTANA DEPARTMENT OF TRANSPORTATION | c:\dgn\4909rot\001.dgn |
| 2 | | 12/10/2012 |
| 1 | | 12:27:17 PM CPS - U1538 |

